

SOLD BY HANNAH & RICHARD

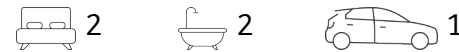

508/38 Milton Street, Ashfield

Sold for \$880,800 (Jul 10, 2025)

SOLD & CONGRATULATIONS

Low Maintenance Central Gem

Proudly located in Ashfield's landmark building "Serenity" designed by renowned architects Dickson Rothschild, this quality 2 bedroom apartment boasts unrivalled views.

Property Features:

- Two spacious bedrooms with built-in robes, balcony access, and ensuite in the main bedroom.
- Stylish kitchen featuring waterfall stone benchtops, SMEG appliances, and a breakfast island.
- Open living and dining areas seamlessly connect to sun-drenched winter garden balconies.
- Designer full bathroom, separate internal laundry, and ducted reverse cycle air conditioning.
- Double glazed windows offering district views, secure basement car space, and storage cage.

Property ID: L4347183
Property Type: Apartment
Building / Floor Area: 106
Open Parking: 1

Tony Andreacchio
 0418 967 900
tony.andreacchio@ashfield.rh.com.au

- Conveniently located a short walk from Ashfield Mall, train station, schools, the new Aquatic Centre, and Liverpool Rd restaurant strip.
- Apartment dimensions: Living area 91sqm, Car space 13sqm, Storage Cage 2sqm, Total 106sqm.
- Council rates: \$370 per quarter, Strata fees: \$1,086 per quarter

Every care has been taken to verify the accuracy of the information contained in this advert, but no warranty (either express or implied) is given by Raine & Horne or its agent, as to the accuracy of the contents. Purchasers should conduct their own investigations into all matters relating to the proposed purchase of property.

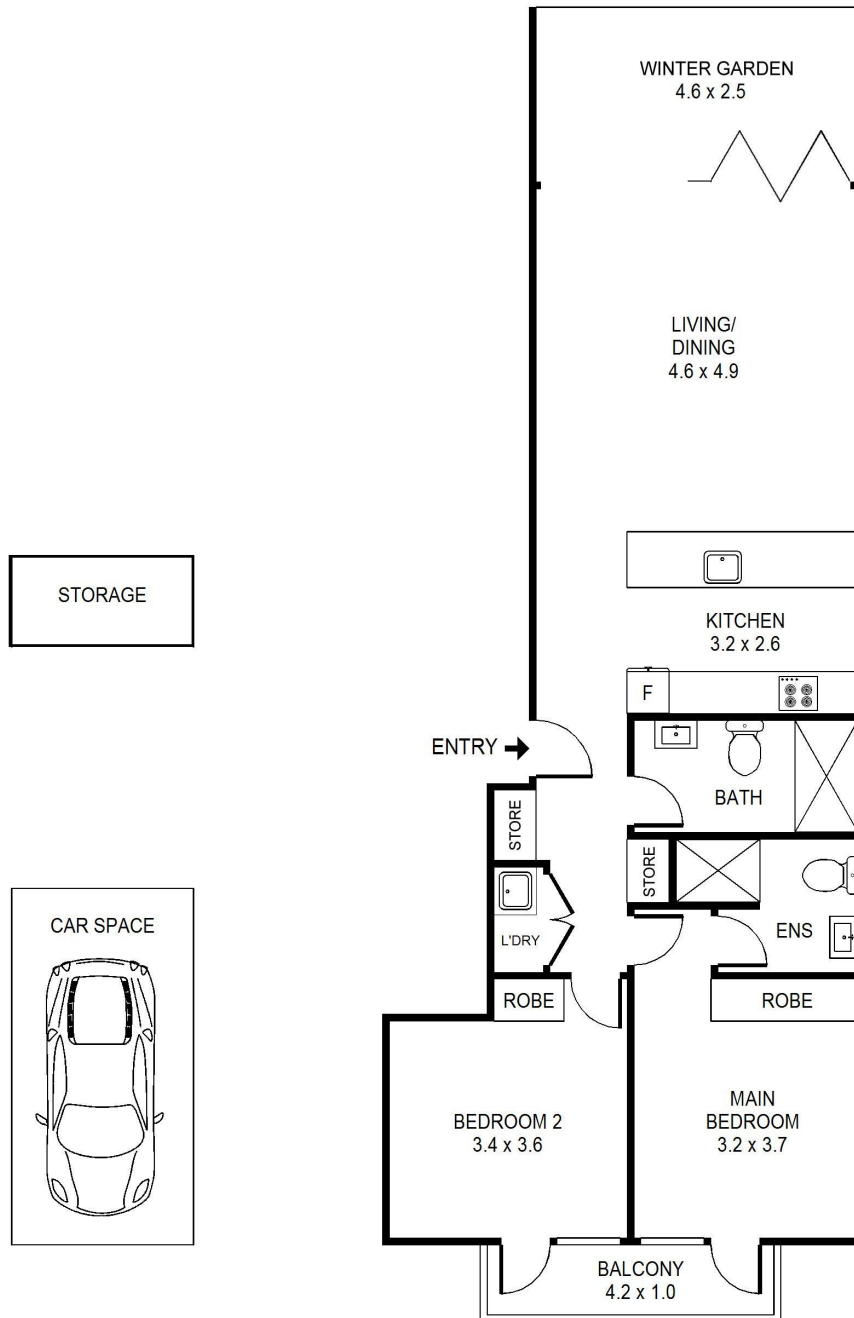

508/38 Milton Street, Ashfield

Raine&Horne®

Note: floor plan measurements are approximate and are intended for illustrative purposes only