

Stunning Town Penthouse Set In The Exclusive Nicholson Reid Complex!



3



2



1

308/600 Nicholson Street, Fitzroy North

Sold Prior To Auction

Located in the heart of charming Fitzroy North, you will find this stunning two-story town apartment. The first floor boasts light filled living space with superb full width timber engineered floors opening out to a private balcony, a state of the art open plan Kitchen with Marble Bench tops & waterfall edging. The top floor comprises of three generous size bedrooms with floor to ceiling built in robes, master with full ensuite and a stunning main central bathroom.

Features:

- 3 Large bedrooms
- Master with full ensuite
- French Oak timber floors
- Wool carpets
- Natural Stone (Marble) bench tops
- European appliances.

Property ID: L26440625

Property Type: Townhouse

Garages: 1

Tony Elezovic

0402 999 500

Tony.Elezovic@brunswick.rh.com.au

- Marc Newson for SMEG Fixtures and Fittings
- Generous storage and cabinetry
- Neutral and elegant palette

Other features include :

- European laundry
- Split system heating and cooling throughout
- Secure entry via video intercom
- Quality 100 % wool carpets
- Private Car parking
- Large balcony
- Marc Newson SMEG Fixtures and Fittings

Nestled within a community rich with the buzz of cafes, bars, restaurants, galleries, parks and boutiques, as well as a tram stop at your door step direct to the CBD. Inspections will be sure to impress.

308/600 Nicholson Street, Fitzroy North

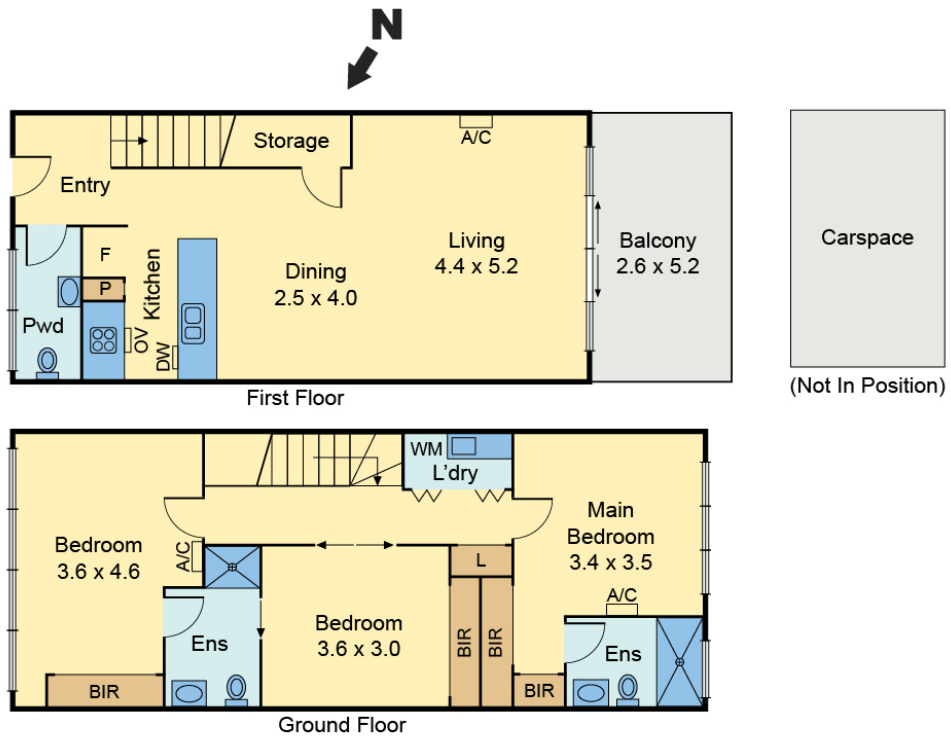

Raine&Horne

All measurements are in metres. This plan is not to scale and provided as marketing material. All measurements are approximate and for illustrative purposes only. We make no guarantee of the accuracy of the plan, and you should independently determine the suitability of the property for your requirements.