



**Corner Site with Development Potential (STCA)**



150s  
qm

## 400 Liverpool Road, Croydon

**SOLD!**

Located at the corner of Liverpool Road and Lion Street, within easy walking distance of CBD-bound bus stops and an array of local shops and restaurants, this original double brick house on a 493 sqm corner block needs your love and attention but offers great development potential for experienced builders, developers, and savvy investors. (STCA)

Land dimensions: (approx)

11.46m/15.24m X 37.03m/36.8m

Land Size: 493 sqm (approx)

FSR: 1.5:1

Maximum Building Height: 13m

Zoning: MU1 (Mixed Use)

Location Features: (all approx)

150m to CBD bound buses

<b>Property ID:</b>	L26683723
<b>Property Type:</b>	Land/Development
<b>Building / Floor Area:</b>	150
<b>Land Area:</b>	493.0 sqm

**Bryan Yu**  
+61415380422  
bryan.yu@burwood.rh.com.au

230m to Ashfield RSL Club

750m to Ashfield Aquatic Centre

800m to Ashfield Shopping Mall

900m to Croydon Station

1km to Ashfield Station

Motivated Vendor, be in it to win it

Disclaimer: The above information has been furnished from sources we deem to believe. We have not verified whether or not that information is accurate, and do not have any responsibility to any person for its accuracy and do no more than pass it on.

All interest parties should make and rely upon their own inquiries in order to determine whether or not this information is, in fact, accurate.



400 Liverpool Road, Croydon

SITE PLAN

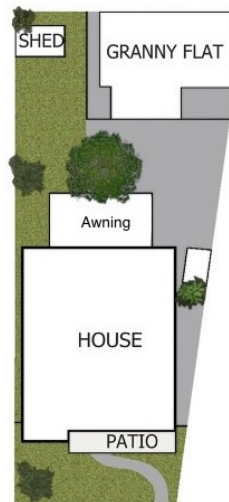

**DISCLAIMER:**

This floor plan is used for marketing purpose only and is subject to errors and inaccuracy. The marketing Agent & Maraj Media will not accept any liability. Interested parties should make and rely on their own enquiries.

FLOOR PLAN



**Total Area 150 Sqm**