



Exclusive 2-Bedroom Apartment in Beecroft Primary School Zone



2



2



1

6/7 Chapman Ave, Beecroft

Sold

Nestled within Building A, this chic apartment stands out as a rare gem in the sought-after Beecroft area. Offering a well-designed layout and contemporary interiors, it resides in one of Beecroft's premier luxury complexes. Merging high-end style with sophistication, this ultra-modern dwelling showcases impeccable finishes and refined living spaces that seamlessly extend to an all-weather balcony.

Features:

- Expansive and adaptable layout, featuring engineered timber flooring in living and bedroom areas.
- Modern kitchen with a sleek breakfast bar, gas cooking, and premium appliances.
- Luxurious bathroom adorned with floor-to-ceiling tiles, a bathtub, and a spacious shower.
- Well-proportioned bedrooms with ample built-in robes, master featuring an ensuite.
- Integrated downlighting, ducted air conditioning, and a state-of-the-art intercom system, ensuring a luxurious and secure living experience

Property ID: L26168472

Property Type: Apartment

Garages: 1

Amanda (Yuan) Yuan

0422513433

amanda.yuan@carlingford.rh.com.au

- One dedicated and secure car space, along with a generously sized storage cage, providing unparalleled convenience for residents

- The complex also features a communal room and an outdoor entertaining area suitable for a variety of events.

Transport, shops, and surrounding facilities:

- Approximately 240 meters to Beecroft Village,

- Approximately 270 meters to Arden Anglican School,

- Approximately 400 meters to Beecroft station and Woolworths, as well as various cafes.

- Located within the catchment areas for Beecroft Public School, Cheltenham Girls, and Carlingford High School.

- Approximately Outgoings: Strata Levy \$1,141/pq; Council Rate \$349/pq.

DISCLAIMER: Whilst every effort has been made to ensure the accuracy of the information contained about this property, it does not constitute any warranty or representation by the vendor or agent. All information contained herein is gathered from sources we consider to be reliable.

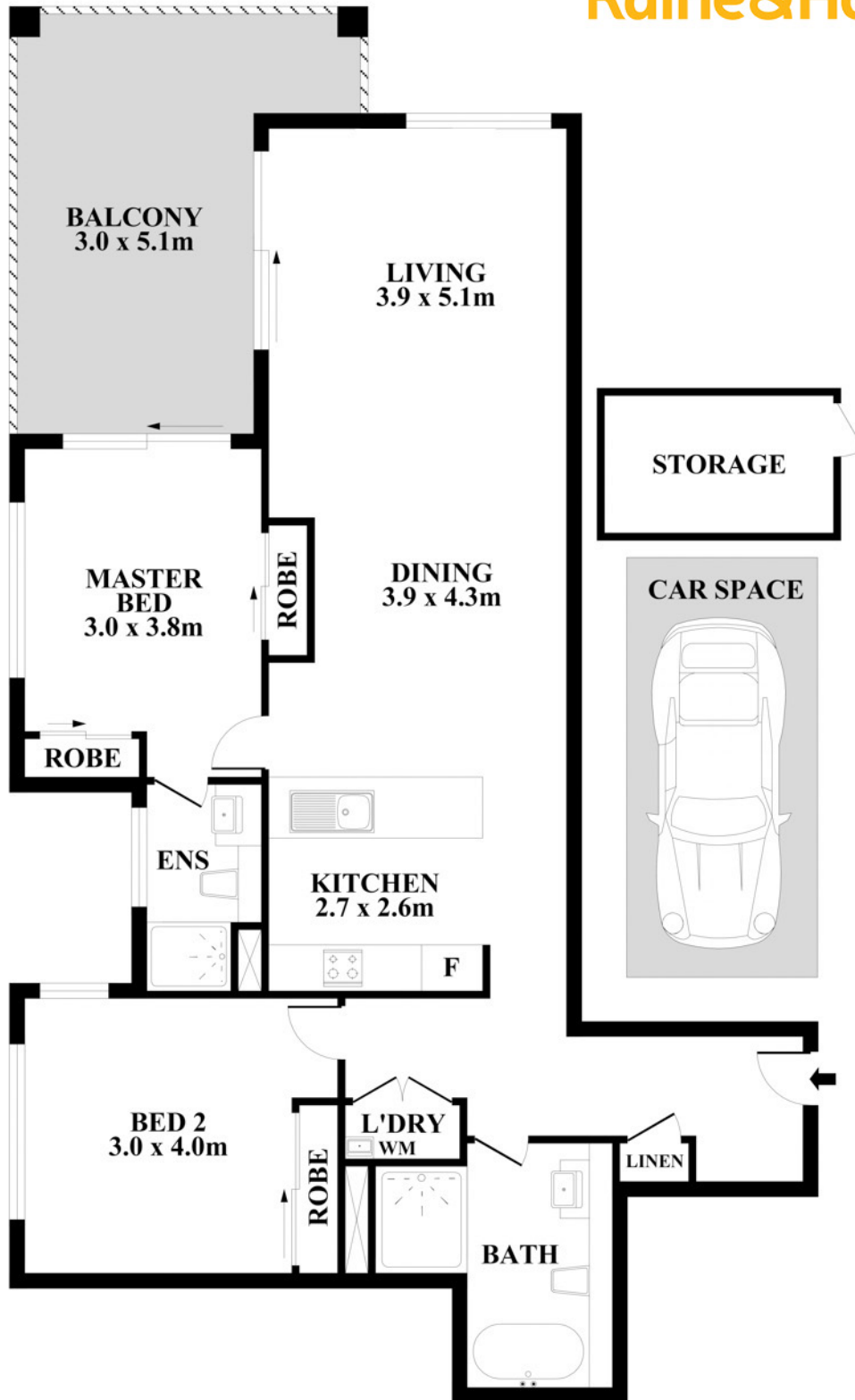

Plans shown are for presentation purposes only and not part of any legal document or title. They are subject to errors, omissions, inaccuracies and should not be used as a sole and accurate reference interested parties should make their own inquiries using independent sources.



6/7 Chapman Avenue, Beecroft