



Top-Floor Apartment (Level 8) with Breathtaking City Views



1



1

84/230 Elizabeth Street, Surry Hills

Price Guide \$650,000

Perched on the top floor of a well-maintained building, this spacious apartment offers the energy of city living just moments from Central Station, Light Rail, Chinatown, and Sydney's CBD. Enjoy stunning park and cityscape views from this stylish one-bedroom residence in a secure building with lift access. Large double-glazed windows fill the open-plan living and dining areas with natural light.

Generous bedroom with mirrored built-in wardrobe and large windows

Modern bathroom with bath, shower, and internal laundry

Well-appointed kitchen with stone benchtops

Ducted air-conditioning for year-round comfort

Only 300m to Central Station

A prime investment opportunity-act fast!

Rental estimate: \$750 – \$770/week

Property ID: L17220950

Property Type: Apartment

Building / Floor Area: 39

Angela Qi

0425 111 688

angela.qi@cs.rh.com.au

Outgoings (approx):

Water Rates: \$157.00 per qtr

Council Rates: \$285.00 per qtr

Strata Rates: \$1,645.00 per qtr

Contact:

Paul Milkuic 0402 420 666

Angela Qi

0425 111 688

Paul Pettenon

0411 180 290

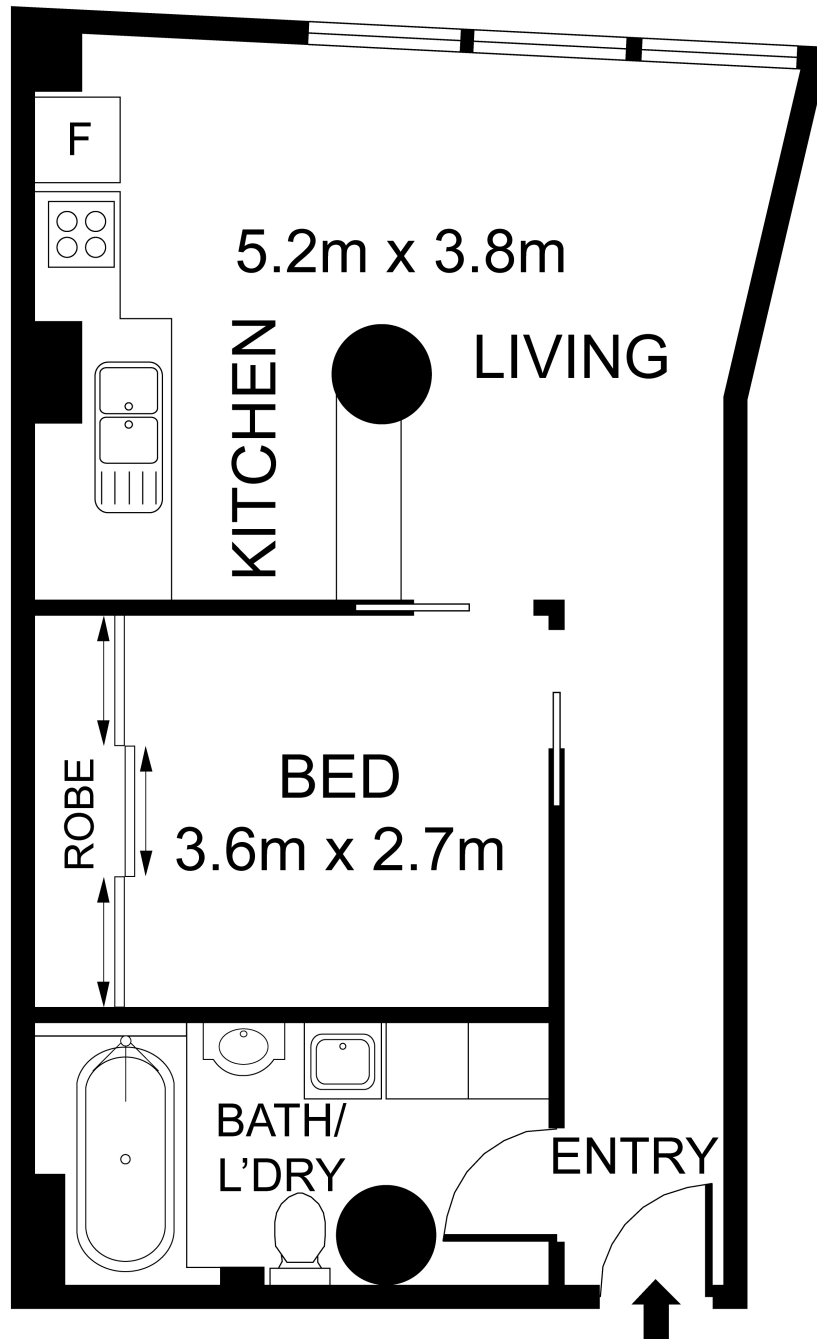

84/ 230 Elizabeth Street, Surry Hills

INTERNAL AREA: 42 SQM APPROX.

DISCLAIMER: 3D Property View accepts no liability for the accuracy of details contained within our floor plans. All plans are drawn and also checked to the best of our ability, however information contained in our floor plans such as area calculations are approximate, and have not been surveyed or drawn to scale. Our floor plans are for representational purposes only and should be used as such. Do not attempt to refer to our floor plans for structural or detailed information.