

**MUCH LOVED, FULL BRICK FAMILY HOME
ON HIGH SIDE OF THE STREET**

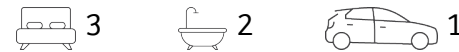

216 Great North Road, Five Dock

Sold Prior To Auction

Enjoy what's on offer with this solid family home situated on an attractive, easement free block of 417sqm, set on the high side of the street. Boasting large room sizes, a separate lounge and dining overlooked by the stunning timber kitchen and opening onto a covered entertainer's patio, all surrounded by manicured grounds with established gardens. 2 bathrooms, internal laundry plus driveway to a lock up garage. Move straight in and enjoy this convenient location. Walking distance to schools, shops and public transport.

- 3 large bedrooms, with high ceilings and tiled floors
- Solid timber eat-in kitchen with ample working benchtops, loads of cupboard space
- Large separate lounge & separate dining area leading to entertainer's yard
- 2 spacious bathrooms along with huge internal laundry. Split system air conditioning
- Paved, gated driveway leads to a lock up garage and private low maintenance yard
- Walking distance to All Hallows Catholic School, Halliday waterfront park and Five Dock shopping, restaurant and café strip

Property ID: L27635627

Property Type: House

Garages: 1

Land Area: 417.0 sqm

Paul Pettenon

0411 180 290

paul.pettenon@cs.rh.com.au

- Conveniently close to the ferry wharf, with a bus stop right at your doorstep
- Take advantage of waterviews from a second storey (STCA)

Enquiries:

Paul Pettenon 0411 180 290

Paul.pettenon@cs.rh.com.au

Paul Milkovic 0402 420 666

Paul.milkovic@cs.rh.com.au

Shirley Tse 0404 781 288

Shirley.tse@cs.rh.com.au



GROUND FLOOR

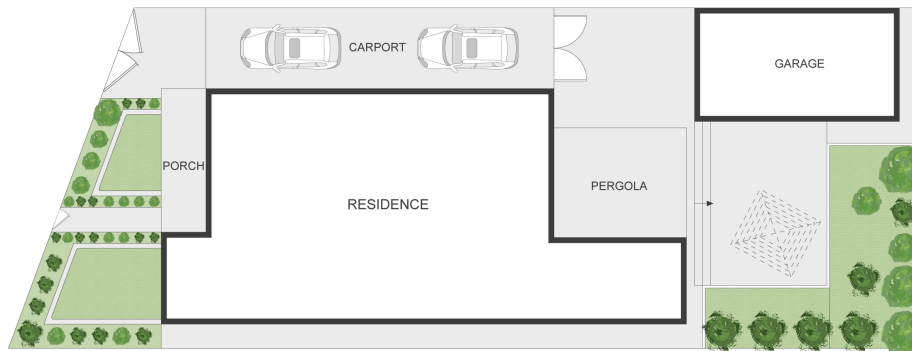

SITE PLAN



FIVE DOCK

216 GREAT NORTH ROAD

DISCLAIMER: Plans shown are for presentation purposes only and are not part of any legal document or title. They are subject to errors, omissions, inaccuracies and should not be used as a sole and accurate reference. Interested parties should make their own inquiries using independent sources.

Raine&Horne®
Concord | Strathfield