

Classic Art Deco apartment in Boutique Block Of Twelve



2



1

4/46 Birriga Road, Bellevue Hill

Sold

Set in a boutique Art Deco block of twelve with a coveted Bellevue Hill address, this well-proportioned apartment delivers an idyllic lifestyle retreat exuding character and charm while brimming with natural light. Enjoying a desirable north east aspect, it reveals warm and welcoming interiors enhanced by high ceilings, polished timber floorboards and wide picture windows. The property has fabulous potential for its new owner to make their mark with an imaginative update or full renovation (STCA). There is a combined living/dining area and a neat eat-in kitchen, while the bedrooms are well-sized and appointed with mirrored built-in wardrobes. Additional features include a bright and airy bathroom, an internal laundry and security intercom access. Promising ultra-convenience in a walk-to-everywhere location, it is situated 600m from Bellevue Road's village shops, cafés and Cooper Park, as well as a short stroll to Hall Street's grocers, buzzing bars, eateries and the iconic Bondi Beach and with a bus stop at your door step.

Property Features:

- Located at the rear of the building with leafy outlook
- Well-proportioned, high ceilings, polished timber floors
- Warm and welcoming lounge room and combined dining area

Property ID: L12098680

Property Type: Apartment

Denise Cameron

0410 444 125

Denise.Cameron@db.rh.com.au

- Neat eat-in kitchen, electric cooktop and ample storage
- Good-sized bedrooms with mirrored built-in wardrobes
- Bright and airy bathroom and internal laundry facilities
- Classic original fixtures, picture rails, picture windows
- Residents enjoy access to a sun washed communal rear garden
- Excellent potential to refresh/personalise/add further value
- Outstanding first home/investment in coveted location
- 600m to Bellevue Road's village shops, cafés, grocers
- Walk to Cooper Park, Hall Street dining precinct, Bondi Beach

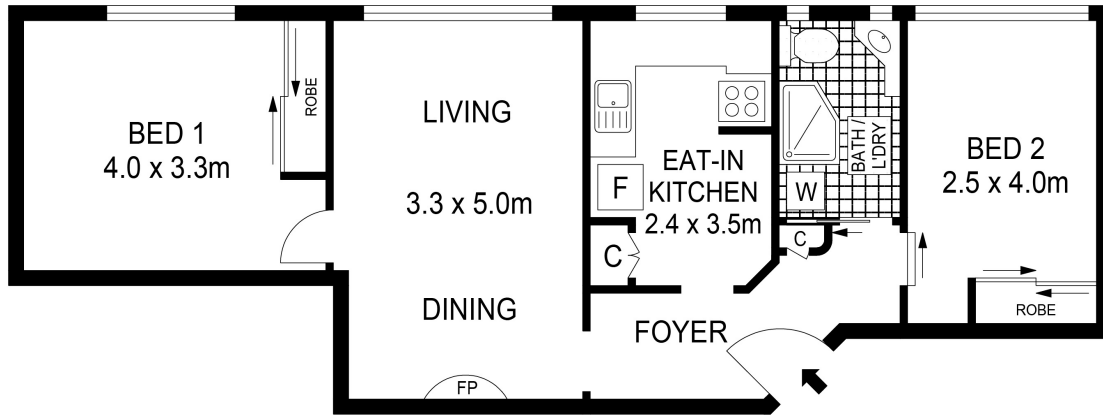

Scale in metres. Indicative only. Dimensions are approximate. All information contained herein is gathered from sources we believe to be reliable. However we cannot guarantee it's accuracy and interested persons should rely on their own enquiries.

4/46 Birriga Road, Bellevue Hill