

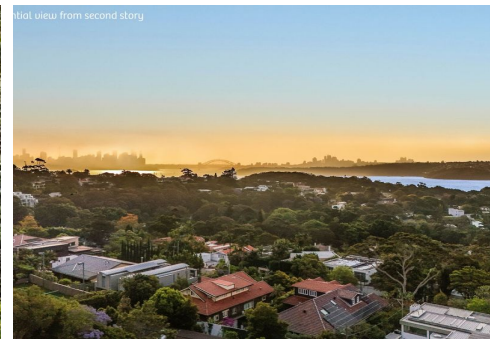

Character Filled Single-Level Family Home on Approx 787sqm Block



4



3



2

53 Hopetoun Avenue, Vaucluse

Sold Prior To Auction

Immaculately presented, this character filled single-level family home offers a harbourside lifestyle of privacy, space and convenience, featuring level land with opportunities to build your dream home or explore dual occupancy with potential for uninterrupted harbour to Watsons Bay views from the second storey (STCA).

Featuring a stylish volcanic stone gourmet gas kitchen with a Lacanche French oven and offers multiple living zones, including a wrap-around sunroom that can double as a study. The bathrooms are elegantly designed with deluxe limestone features. The main bedroom comes with an en-suite and a walk-in robe, ensuring a comfortable and private retreat.

Step outside to find a covered entertainer's deck that opens onto a beautifully manicured terrace garden, perfect for hosting gatherings and enjoying the outdoors.

Property Features:

- Offering an ideal combination of elegance and convenience
- Level land with the ability to build your dream home or dual occupancy (STCA)
- Volcanic stone gourmet gas kitchen with Lacanche French oven

Property ID: L26400825

Property Type: House

Garages: 2

Land Area: 787.0 sqm

Richard Faludi

0430 059 426

richard.faludi@db.rh.com.au

- Multiple living zones & wrap-around sunroom/study
- Deluxe limestone bathrooms
- Main bed with en-suite & walk-in robe
- Covered entertainers deck at the rear leads to manicured terrace garden
- Air conditioning & ceiling fans
- Timber floorboards throughout
- Plantation shutters, French doors & high ceilings
- Garage & house entry via Serpentine Pde
- NBN internet & C-Bus lighting
- Walk to harbourside beaches, including Parsley Bay & Kuttie Beach
- Moments to elite schools, local shops, cafes & Watsons Bay ferry

In conjunction with Warren Ginsberg & Claudia Brunker from Ray White Double Bay

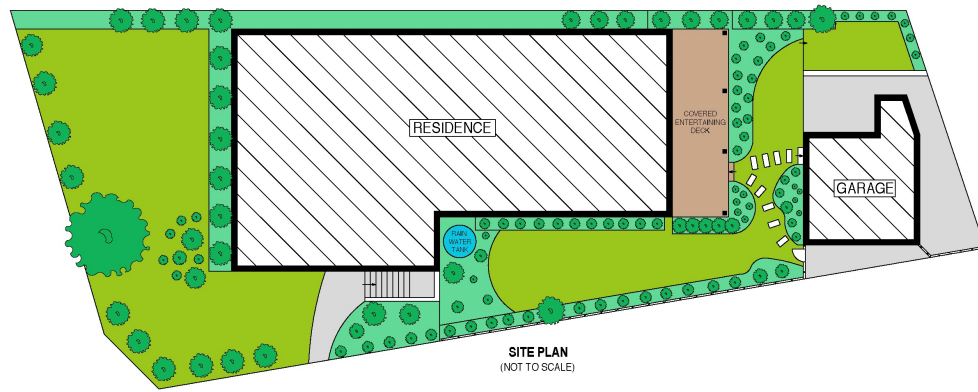

Scale in metres. Indicative only. Dimensions are approximate. All information contained herein is gathered from sources we believe to be reliable. However we cannot guarantee it's accuracy and interested persons should rely on their own enquiries.

53 Hopetoun Avenue, Vauluse