

Stylish Living Flowing to Wrap Around Courtyard



2



2



1

5/142 Francis Street, Bondi Beach

Sold Prior To Auction

Peacefully nestled in a discrete cul-de-sac setting and adjacent to the tropical rainforest sanctuary of Thomas Hogan Reserve this recently updated, stylish 2-bedroom modern apartment captures a leafy outlook and features stunning interiors flowing to wrap around courtyard. Situated in the boutique security building "Parkview", this apartment offers ultimate charm with privacy, ground floor entrance and lift access to basement parking. Entertaining is a must in this beautiful apartment with open-plan Caesarstone gas kitchen and large living & dining areas flowing to a covered alfresco terrace, main king-size bedroom (with b/ins & ensuite), 2nd bedroom and main bathroom. The home is conveniently located within minutes to Bondi Junction's selection of shopping, dining, parks, schools, transport and is only a moments stroll to the iconic stretch of Bondi Beach.

Property Features:

- Two large bedrooms with built in robes
- Main bedroom with ensuite
- Both bedrooms with access to private outdoor courtyard
- Large kitchen with new benchtop and splash back

Property ID: L26840764

Property Type: Apartment

Garages: 1

Ric Serrao

0412 072 178

Ric.Serrao@db.rh.com.au

- Large living and dining room flowing on to covered terrace area
- Ample storage throughout the apartment
- Light timber floors, carpet in the bedrooms
- Internal laundry, secure car space
- Located to the rear of the block, quiet position

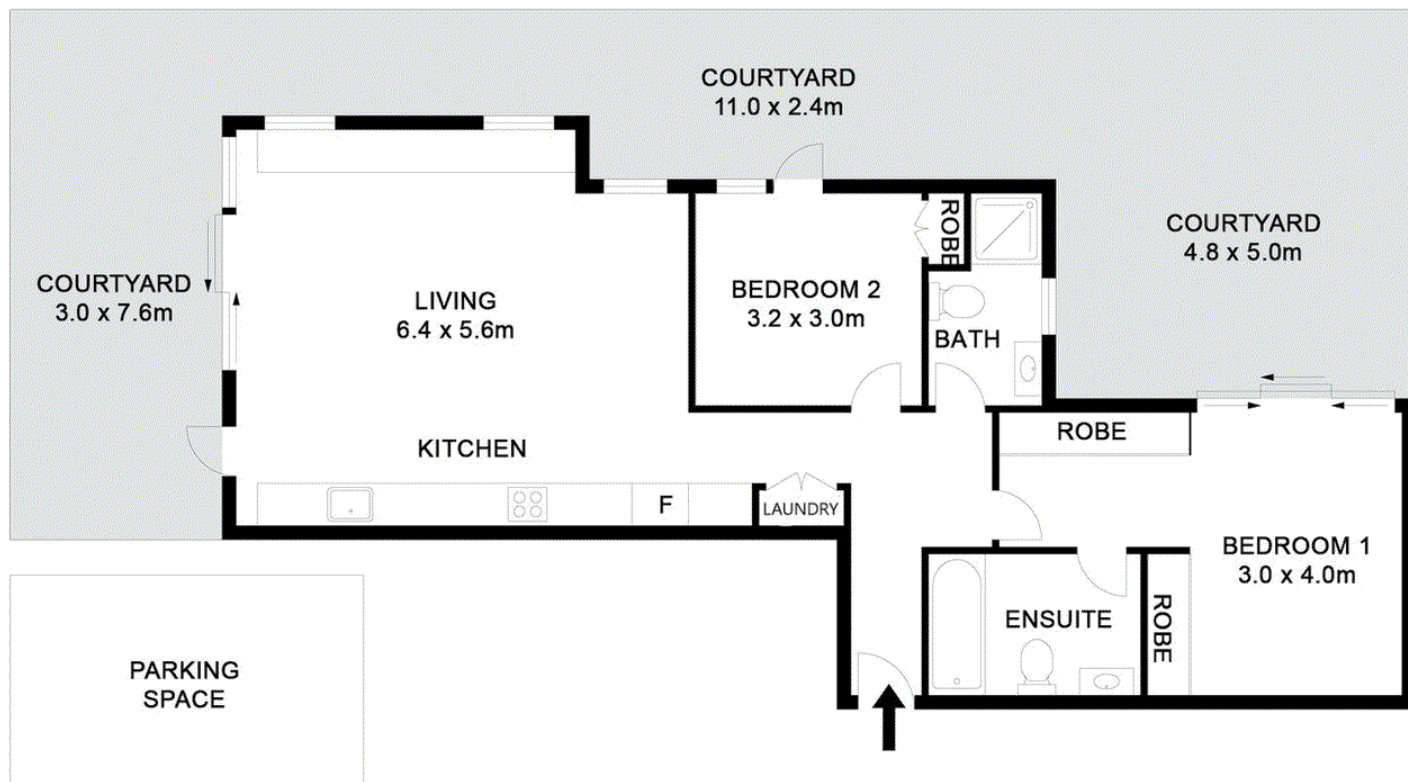

Scale in metres. Indicative only : Bee Hive Studio floor plans / site plans are intended as an approximate guide only. No representations or warranties of any nature are given.

Francis Street, Bondi Beach