



Discover Your Dream Home: A Charming Two-Story Haven



2 1 1

18/23-29 Newton Street, Goulburn

Sold for \$425,000 (Jul 15, 2024)

This delightful two-story townhouse offers a perfect blend of functionality and style, promising a lifestyle of ease and tranquility.

- The ground floor welcomes you with a generously proportioned living area that seamlessly transitions into the dining space, creating an inviting atmosphere for relaxation and entertainment.
- Sleek & modern kitchen, equipped with electric cooking appliances, where every meal preparation becomes a delight.
- Ascend to the second floor (15 stairs) to discover two spacious bedrooms, each adorned with built-in robes, providing ample storage space for your personal belongings.
- Private balconies: Enjoy the luxury of direct access to private balconies from both bedrooms, offering a serene retreat to bask in the sunshine or unwind amidst the evening breeze.
- Indulge in the tastefully designed bathroom featuring a separate toilet for enhanced privacy and convenience, ensuring a rejuvenating experience for you and your guests.
- For added ease, the internal laundry is conveniently situated adjacent to the second toilet on

Property ID:	L27587615
Property Type:	House
Building / Floor Area:	73
Garages:	1
Land Area:	172.0 sqm

Zeb Alaia  
0408 662 944  
Zeb.Alaia@goulburn.rh.com.au

the lower level, simplifying your daily routines.

- Single lock up garage with internal access
- Step outside to a private & spacious backyard, perfect for outdoor gatherings, gardening enthusiasts, or simply basking in the serenity of your own outdoor oasis.
- Nestled in a tranquil and welcoming neighborhood, this townhouse offers a peaceful retreat from the hustle and bustle of city life, while still providing easy access to nearby amenities, schools, parks, and public transportation.

Fantastic tenants in place currently paying \$410pw. Experience the epitome of modern living in this charming townhouse. Schedule a viewing today and seize the opportunity to make this your own slice of paradise in a vibrant and thriving community.

Strata \$487pq covers roof, windows, back door, garage door, front lawns (not back) and common areas.

Council \$1000pa

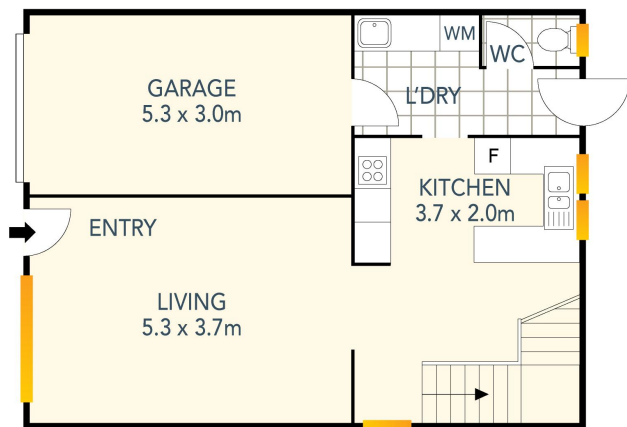

GROUND FLOOR

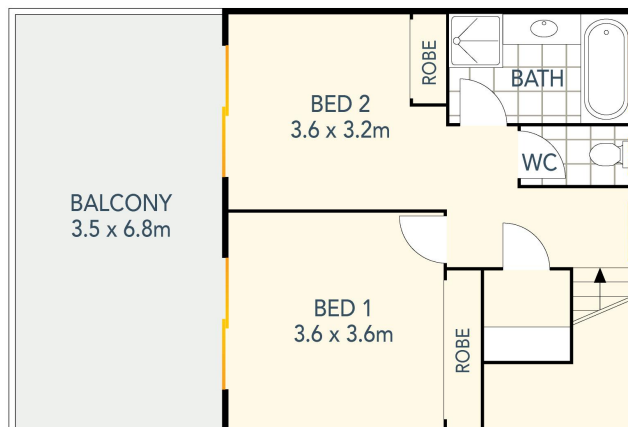

FIRST FLOOR

DISCLAIMER: Plans are artist's impressions only and intended as an approximate guide. Plans may not be drawn to scale.

23 Newton St 18, Goulburn

Produced by **PATRAMA**  
Raine & Horne