



Sold - Sam Karatasas - 0418 280 923 & Spiro Spinoulas - 0431 763 151



2



1

132 Australia Street, Camperdown

Auctioned for \$1,600,000 (Jun 22, 2024)

Rare Opportunity in a tightly held pocket of Camperdown

Tucked away in a prime Camperdown enclave, 132 Australia Street, Camperdown represents an exciting opportunity to create your ideal urban lifestyle sanctuary. This corner parcel provides three street frontages, the property comes with two bedrooms, sun-washed garden area with potential to create a car space at the rear of the property.

This classic period terrace is full of opportunities to upgrade or renovate (STCA) whilst also being complemented by a highly prized Parkside positioned footsteps to Camperdown Memorial Rest Park, King Street dining & amenities, RPA hospital, schools and transport options.

Property Features Include:

- Currently an original 2-room brick dwelling
- Corner position, with three street frontages
- Easily convert the rear yard to a parking space via the rear lane access

Property ID: L26855727

Property Type: House

Land Area: 113.0 sqm

Sam Karatasas

0418 280 923

sam.karatasas@kk.rh.com.au

- Charming character façade and streetscape
- Potential to create a chic boutique Camperdown terrace (STCA)
- Redesign to maximise indoor/outdoor flow (STCA)
- Rare opportunity for investors and renovators
- Within easy walking distance to King Street amenities & dining, Sydney University, RPA Hospital & public transport to Sydney CBD

Please contact the exclusive selling agents for more information.

Sam Karatasas: 0418 280 923

Spiro Spinoulas: 0431 763 151

Open For Inspection

Saturday:

11:30am-12:15pm

Thursday:

11:30am-12:15pm

Auction

Saturday 22nd June at 12:00pm – 12:30pm

On Site

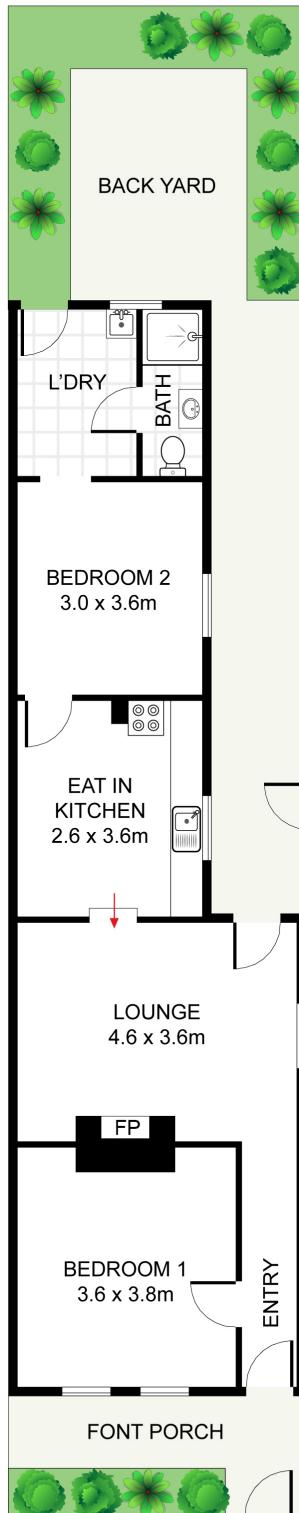

Raine&Horne.
Kingsford | Kensington

132 Australia Street, Newtown

DISCLAIMER: PLANS SHOWN ARE FOR PRESENTATION PURPOSES AND ARE NOT PART OF ANY LEGAL DOCUMENT. ALL MEASUREMENTS AND FIGURES ARE APPROXIMATE.