

Secure Elevated Unit In This Prime Near City Location!!



2



1



1

14/151 Anzac Highway, Kurralt Park

Sold for \$390,500 (Jul 16, 2024)

Just waiting for you to move in, or add to your investment portfolio, this spacious unit features:

- Secure elevated position at the rear of the group
- The entrance is into the lounge room with its floating timber flooring, lofty ceilings, ample natural light coming through the windows, reverse cycle air conditioner, and access to the private front balcony
- Both bedrooms are a great size with the main bedroom having built in cupboards and split system air conditioning
- Separate kitchen / meals area with rear balcony access
- Full bathroom including a combined washing machine space
- Situated in this perfect position within easy walking distance to the local shopping centre
- Ultra convenient location between the City and Beach, public transport only a minute away, and easy access to the airport too!

Property ID:	L9458460
Property Type:	Unit
Building / Floor Area:	69
Carports:	1

John Cullen

0411 607 888

john.cullen@kp.rh.com.au

- Ideal as a first home or an excellent addition to your investment portfolio
- Potential rent return of \$365pw (approx)

Not To Be Missed!!

Outgoings:

Council: \$1,066pa

SA Water: \$153pq

ESL: \$93.80pa

Strata: \$339pq + \$335pq sinking fund

NB: Kindly note that select images used within our promotional content have undergone virtual staging processes, showcasing possible arrangements and aesthetics within the property.

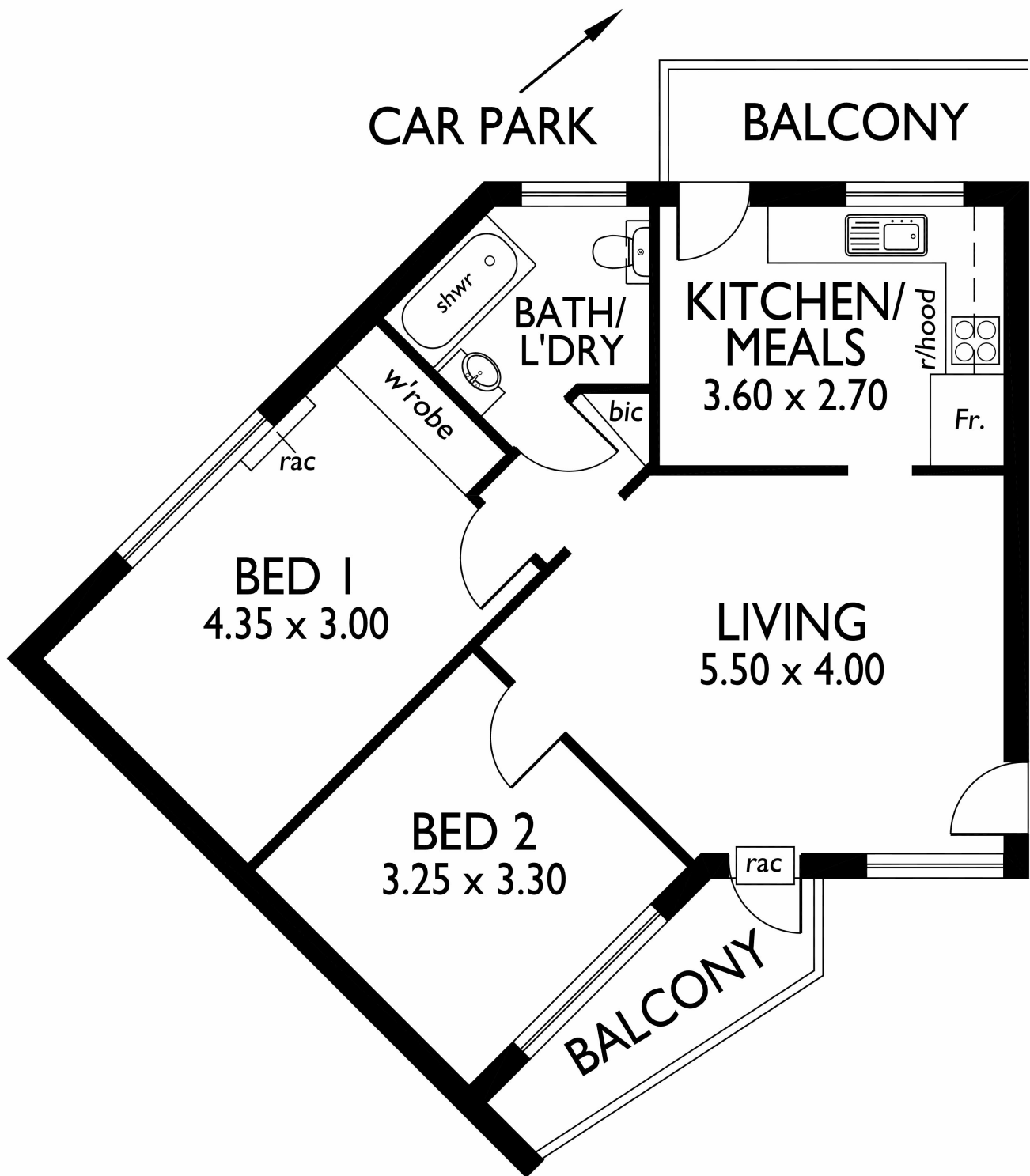

This drawing is for illustration purposes only. All measurements are approximate only and information intended to be relied upon should be independently verified.