



Modern Industrial Unit



235s
qm

2/63 Northcote Street, Kurri Kurri

\$35,000pa + GST includes outgoings & water

Located within the new Jasper Arlo Centre in Kurri Kurri, this quality industrial warehouse is now available for lease.

Positioned just 5 minutes from the Hunter Expressway, this modern warehouse boasts a high clearance design coupled with great exposure off the busy Northcote Street thoroughfare.

The busy complex built in 2021 provides on-site parking for staff and customers (undesigned) and has a high profile tenant in the new million dollar iGym Kurri Kurri.

UNIT 2

- Total 235m² floor space
- \$35,000pa + GST
- Includes all outgoings & water
- 1 roller door + private access door
- Internet ready to connect to

Property ID:	L24025354
Property Type:	Industrial/Warehouse use
Building / Floor Area:	235

Carolyn Wallis-Tomlins

0488 061 192

carolyn.wallistomlins@kurri.rh.com.au

- 3 phase power
- Toilet & kitchenette facilities
- 24 hour access
- Exposure to busy Northcote Street

Please contact leasing agent Carolyn Wallis-Tomlins on 0488 061 192 for further details & to arrange an inspection.

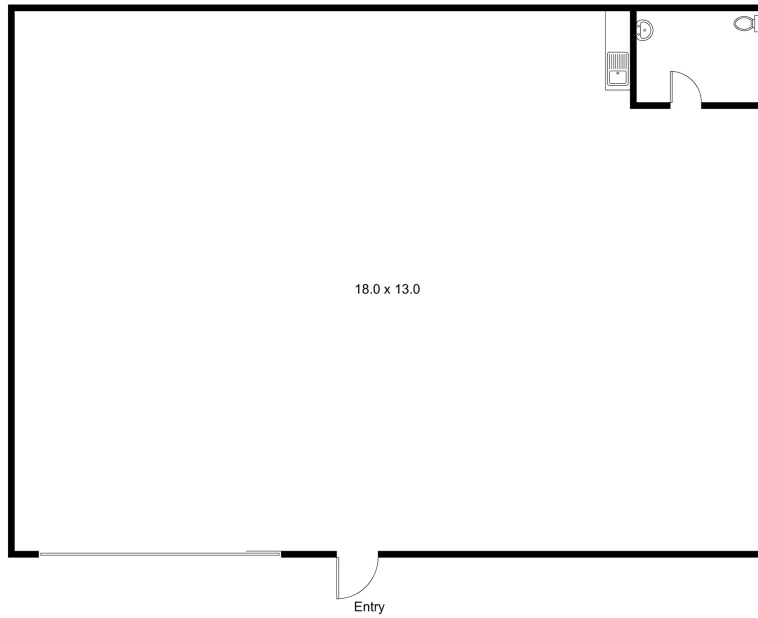

2/63-73

Northcote St,
Kurrk Kurri

Shed Total - 235 m²

Illustration for identification purposes
only, measurements are approximate
only and not to scale