



Tranquil urban-cool in the spectacular heart of The Canopy district



310/17-21 Finlayson Street, Lane Cove

Sold Prior To Auction

Everything you want is right where you need it in this exemplary apartment offering high-calibre contemporary chic. Enjoy a premium lifestyle with all the leisure and pleasure of Lane Cove right at your door, and transport just a stroll away. Elevated with a sunny northeast aspect, the apartment is centred in a beautifully landscaped security complex that tames the urban location with instant tranquillity. Freshly painted interiors radiate with natural light across the open living and dining area and the restful double bedroom. Miele showcases in the well-appointed gas and stone kitchen. Entertain on the covered balcony or in the communal barbecue garden or meet friends for a meal at one of the amazing local eateries. Fantastic for busy professionals, downsizers, or for leasing out.

- Modern and tranquil right in the vivacious heart of The Canopy district
- 79sqm total on title, elevated single level interior with northeast aspect
- Security building wrapped in landscaped gardens with great street appeal
- Freshly painted interiors accented with high-quality neutral tone finishes
- Large sun-spilled living and dining with full height glass sliders to balcony

Property ID: L20486698

Property Type: Apartment

Open Parking: 1

Mary-Anne Fitzgerald

0418 648 654

maf@lms.rh.com.au

- Miele kitchen with gas cooktop, oven, dishwasher, stone benchtops
- Generous peninsula breakfast bar, microwave hutch frees counter space
- Covered balcony catches the sun and looks across landscaped leafiness
- Light and quiet double bedroom with a generous built-in wardrobe
- Sleek fully tiled bathroom, shower, mirror storage, concealed cistern
- Internal laundry room – rare for a one-bedder – with tub, dryer, and storage
- Ducted reverse air conditioning, video intercom, security lift to all levels
- Parking in secure basement with storage cage, plentiful visitor parking
- On-site communal barbecue garden perfect for an alfresco lunch
- Footsteps to comprehensive bus routes for City and Greater Sydney
- Stroll to The Canopy and Lane Cove village entertainment, retail, eateries

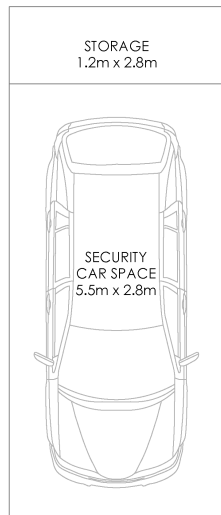

B2 CARPARK

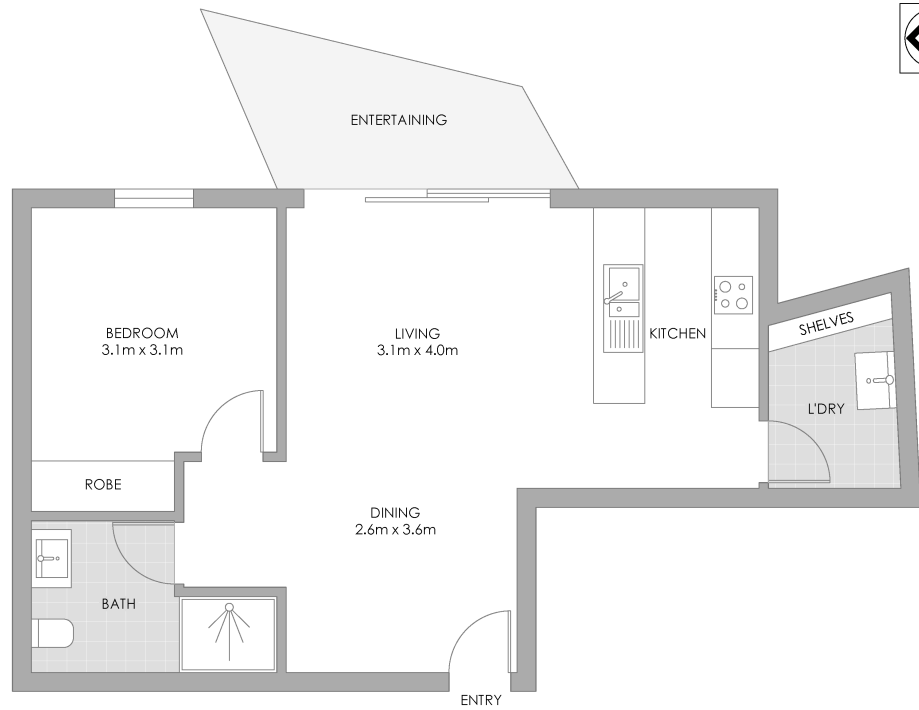

310/17-21 Finlayson Street, Lane Cove

PLANS SHOWN ONLY INDICATIVE OF LAYOUT. DIMENSIONS ARE APPROXIMATE.
Measurements are approximate and not to scale. The vendor, agency and supplier will accept no liability for its accuracy. Interested parties are advised to make their own independent enquiries.

Raine&Horne
Lower North Shore