



House-like ambience



3



1



1

9/5 Balfour Street, Greenwich

Sold for \$1,330,000 (Aug 10, 2024)

Enjoy all the comforts of home in this house-like double brick apartment that makes a perfect upsize for busy young families wanting carefree living, spiced with convenience. Set in quiet and private surrounds, the elevated ground floor layout rests in a sunny north corner position with only one common wall and showcases classic style accented by exquisite timber floors. The open living and dining area seamlessly blends with a screened balcony that expands the living space with palm fringed tranquillity. The striking modern kitchen delivers gas cooking, plentiful storage, and excellent natural ventilation. Three large bedrooms are serviced by a beautifully renovated bathroom. From here it's a simple walk to St Leonards rail, City buses, Greenwich Public School, and Gore Creek Reserve.

- 100sqm on title plus 16sqm exclusive use, one common wall, block of only 12 units
- High ceilings with detailed cornices, timber floors, elegant European ambience
- Spacious living and dining with gas heating and bi-fold doors to the balcony
- Kitchen with gas cooktop, oven, dishwasher, drawer storage, pantry cupboards
- Three versatile bedrooms, built-in robes to two, master with pretty district view

Property ID: L28484148

Property Type: Apartment

Garages: 1

Mary-Anne Fitzgerald

0418 648 654

maf@lms.rh.com.au

- Renovated bathroom with a cleverly integrated laundry plus a separate toilet
- Beautifully manicured and useable communal garden, high side of the street
- Lock up garage with motorised door, covered access, separate storage cage
- Walk to St Leonards rail, City buses on River Rd, bus at gate for North Sydney
- Meander through Gore Creek track to Bob Campbell Oval and waterfront
- Walk to Greenwich Public School, near Lane Cove and Crows Nest entertainment

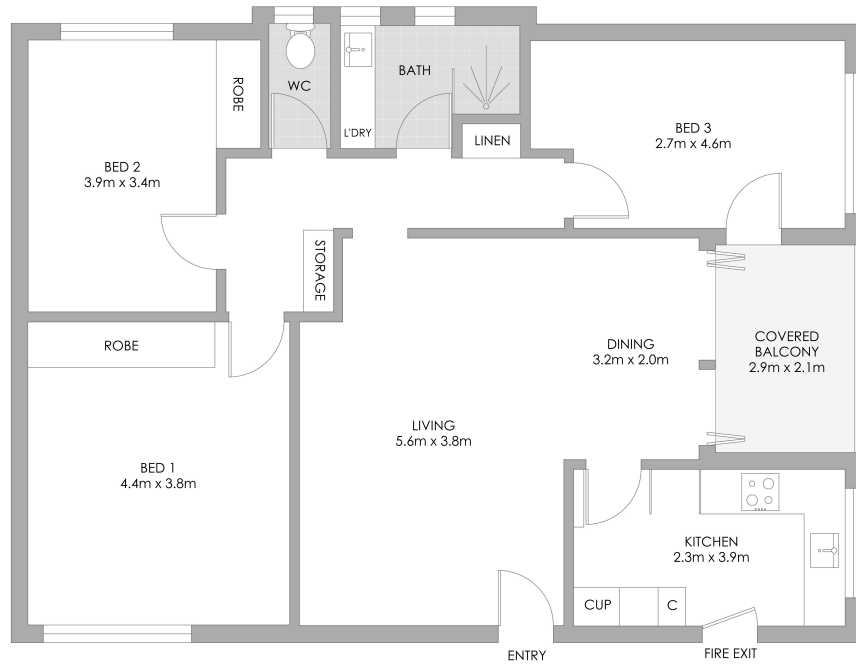
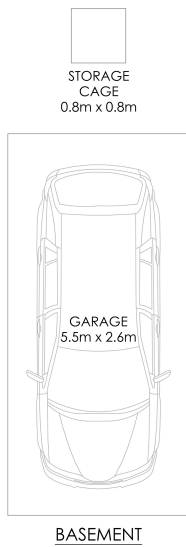

9/5 Balfour Street, Greenwich

PLANS SHOWN ONLY INDICATIVE OF LAYOUT. DIMENSIONS ARE APPROXIMATE.
Measurements are approximate and not to scale. The vendor, agency and supplier will accept no liability for its accuracy. Interested parties are advised to make their own independent enquiries.

Raine&Horne
Lower North Shore