



## Architectural Style with Natural Wonders



4



2



2

## 126 Crisp Drive, Ashby Heights

Sold for \$1,170,000 (Jun 10, 2025)

126 Crisp Drive is a spectacular, Witzig designed, 4-bedroom, 2-bathroom home set high on the hill in Ashby Heights. It has equally spectacular views over the Clarence River delta and on to the East Coast fringe with Angourie as your back drop.

This 4 acre property is a treasure trove of environmental secrets, with views to the beautiful old growth timber and established gardens with a walking track, enabling you to appreciate all the local Flora and Fauna. The home was built to settle into its environment and take full advantage of the position but not compromise on quality, functionality and liveability. These desired requirements have all been achieved and this is a property that any discerning buyer will be proud to call home.

The first thing you notice when arriving at the property is the view. From the moment you walk through the front door you can literally see for miles and miles, taking in the views of the Ashby ridge line and onto the East Coast. This home is a celebration of the senses, with wide hallways, cathedral ceilings large bedrooms with built ins, a fully appointed kitchen with a central island bench, and a comfortable open plan living and dining room, the latter taking full advantage of the spectacular views. These spaces are very appealing and functional, with the ducted air conditioning providing comfort across the seasons.

The kitchen combines perfectly with the main outdoor entertaining verandah, a spot you will

**Property ID:** L23490554

**Property Type:** House

**Garages:** 1

**Carports:** 1

**Land Area:** 1.6 hectares

**Angus Suttor**

0436 006 717

[angus.suttor@myi.rh.com.au](mailto:angus.suttor@myi.rh.com.au)

find yourself spending a lot of time on as it allows you to embrace our beautiful North Coast climate.

The master bedroom is in a private wing of the home with its own deck taking in the easterly views and will have you waking each and every day to the view and the gift that mother nature has on display. That could be an alluring mist over the hills or a summer storm off in the distance. The ensuite and walk in robe complement the space along with the office space. It is a place of dreams that will appeal to many but will only be truly appreciated by the one lucky enough to call this property home.

The balance of the bedrooms are in the opposite wing of the home and are filled with natural light and have views of the garden and beyond. They are air-conditioned for comfort across the seasons and convenient to the main bathroom.

A couple of the extras in this home are the downstairs bedroom / teenage retreat / pool room / reading room, an area to escape the madness, relax, read a book or watch an old movie. Either way it is a room designed for relaxation, and with its downstairs location, it is sure to have the desired effect.

With the 7Kw solar array and the 60,000 litres of rain water, you have the complete package enabling you to enjoy the home and offset some of the increasing cost of living. Outside there are tranquil, landscaped gardens around the home, that blend perfectly with the natural landscape. The garden contains an array of ornamental plants, to attract the birdlife, fruit trees from Mangos to mixed Citrus, a veggie patch, coffee tree and many more, providing a seasonal flow of fresh fruits and veggies.

All in all, 126 Crisp Drive Ashby Heights is a stunning home in a spectacular location and the owners of this property have made the difficult decision that it's time for a change, thereby giving you the opportunity to secure a property that will reward you with a lifestyle that is sought by many, but only achieved by the lucky few.

Call today to arrange your private viewing for the opportunity to secure the property that you have only dreamt of.

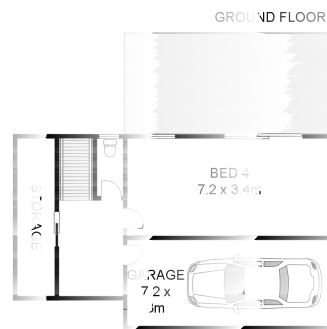

126 Crisp Dr Ashby

Whilst every attempt has been made to ensure the accuracy of the floor plan contained here, measurements of doors, windows, rooms and any other items are approximate and no responsibility is taken for any error, omission, or mis-statement. This plan is for illustrative purposes only and should be used as such by any prospective buyer.