



Beautifully Presented Three Bedroom Apartment



3



2



2

99/1-3 Coronation Avenue, Petersham

\$950 per week

Set within the resort-like grounds of the sought after Eversleigh Estate this beautifully maintained residence combines bright interiors with contemporary style and class. The home features an open plan living and dining area, designer granite kitchen with stainless steel appliances, three spacious bedrooms; master with private ensuite, and three sundrenched balconies capturing panoramic district views. This complex presents lifestyle inclusions, offering a swimming pool, tennis court and a fully equipped gym all common property to the complex, making this unit the perfect property to call home.

AVAILABLE FOR 6-MONTHS LEASE ONLY

Key Features

- Open plan living & dining area
- Designer Granite Kitchen with stainless steel appliances
- 3 spacious bedroom, master with ensuite
- 3 sundrenched balconies

Property ID: R2397752
Property Type: Apartment
Garages: 2

Iris Inoc
 02 9560 7599
iris.inoc@mdh.rh.com.au

- Swimming pool common to complex
- Tennis court common to complex
- Gym facility common to complex

Petersham, 2049

Petersham is located just 6 kilometres south-west of the Sydney central business district. The area is renowned for its large Portuguese community which is reflected in the various eateries and business throughout the area. Petersham has excellent transport links with a number of bus routes servicing the area along with Petersham Railway. The main shopping precinct is located along New Canterbury Road, with further shops and business lining Parramatta Road which passes along Petersham's northern border.

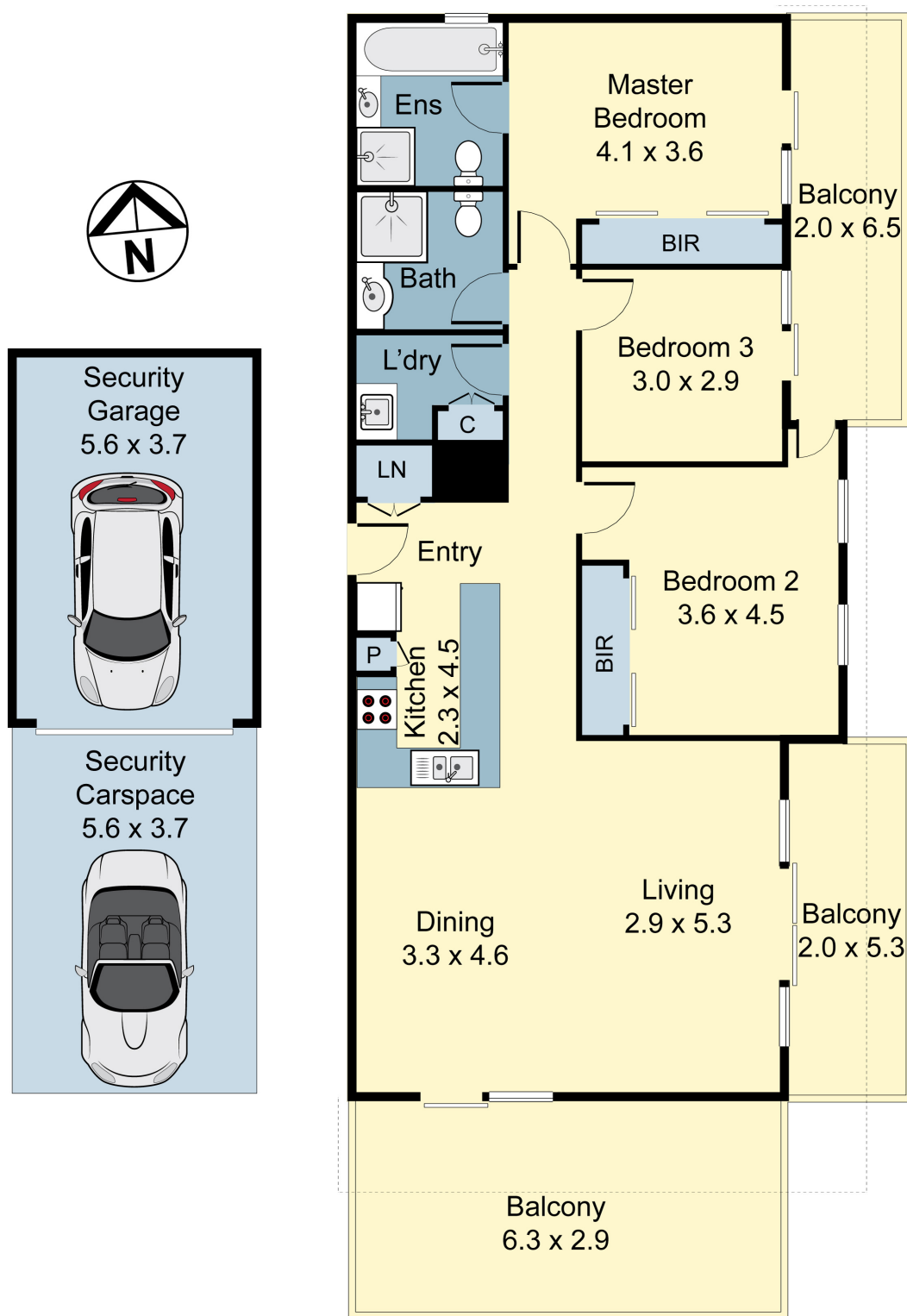

Raine&Horne®

99/1 Coronation Avenue, Marrickville

DISCLAIMER: PLANS SHOWN ARE FOR PRESENTATION PURPOSES AND ARE NOT PART OF ANY LEGAL DOCUMENT. ALL MEASUREMENTS AND FIGURES ARE APPROXIMATE.