



Sub Penthouse - Massive Entertaining Terrace - Panoramic Water Views of Balmoral



35/2 Clifford Street, Mosman

Sold

Experience breathtaking panoramic views of Middle Harbour, stretching all the way to Sydney Heads and beyond, from this stunning one-bedroom sub-penthouse apartment featuring elevator access. Nestled on the sunny Balmoral slopes, this solidly built gem is just moments away from Balmoral Beach and the vibrant Mosman Village known for its cosmopolitan cafés, delis and shops.

- Uninterrupted water views over Balmoral, Middle Harbour and Manly
- Located in a brick complex with convenient lift access
- Mere steps to the B-Line city bus service
- Spacious 203sqm (approx) of living space including the large entertaining terrace.

This property is an exceptional investment opportunity or perfect home for the discerning buyer!

Property ID: L1583571
Property Type: Apartment

Brendan Warner
0415 223 300
brendan@rhm.com.au

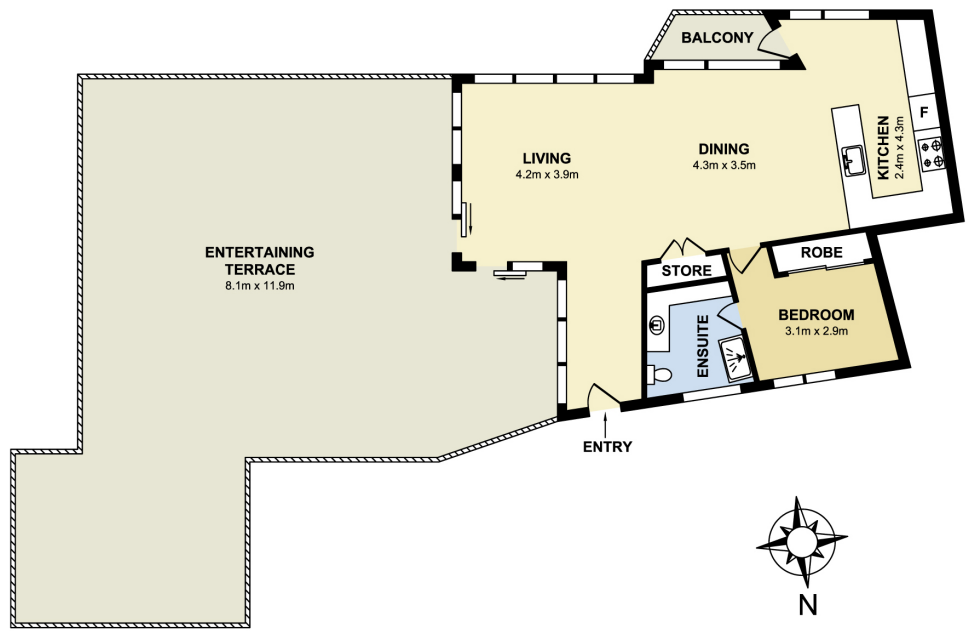

35/2 Clifford Street, Mosman

Measurements are approximate. Not to scale. Illustrative purposes only.
We do not take any responsibility for any information supplied.

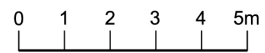

Raine&Horne
Mosman