



Relax & Entertain



4



1



2

2 Strathmore Road, Mallabula

Sold for \$755,000 (Jul 03, 2024)

This impressive single-level home offers a relaxed and inviting atmosphere, perfect for families or those who love to entertain. With four bedrooms and a sprawling 854sqm block backing onto a Crown reserve, you'll enjoy an abundance of space both inside and out.

Step inside to a formal entry that leads to a spacious living room, perfect for movie nights or relaxing. The four bedrooms all feature built-in robes and ceiling fans for year-round comfort, ensuring everyone has their own haven.

The stylish kitchen boasts quality appliances, ample cabinetry, and a large double sink, making meal prep a breeze. It seamlessly flows into the dining area and out to the expansive alfresco entertaining area, ideal for hosting gatherings of all sizes. Take the fun outdoors and enjoy the sparkling inground pool with new colourbond fencing.

This property caters to all your storage needs, featuring a large double lock-up shed with drive-through access to a secure backyard. There's even a separate lock-up garden shed. Whether you have a boat, caravan, trailer, or simply love having extra space, this home has you covered.

The secure backyard provides a safe haven for children and pets to play, while the sparkling pool offers endless summer fun. Conveniently located near preschools, schools, shopping

Property ID: L912470

Property Type: House

Garages: 2

Land Area: 854.0 sqm

Louise Highnam

0402 241 713

louise.highnam@nbltp.rh.com.au

centers, sporting facilities, and the waterfront, you'll have everything you need at your fingertips.

Every care has been taken to verify the accuracy of the information contained in this advertising copy, but no warranty (either expressed or implied) is given by Raine & Horne or its agent as to the accuracy of the contents. Purchasers should conduct their own investigations into all matters relating to the proposed purchase of the property.

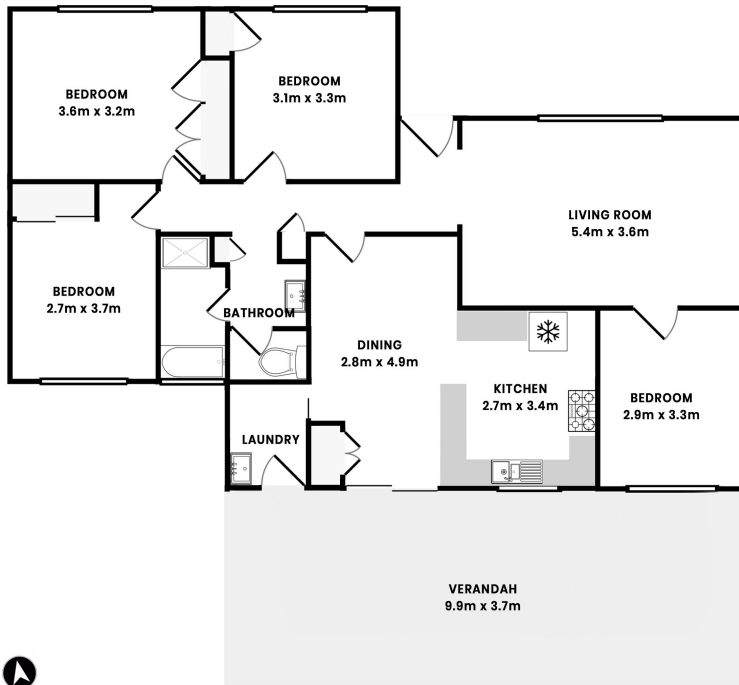

ENTRANCE FLOOR
APPROX FLOOR AREA 138.3m²

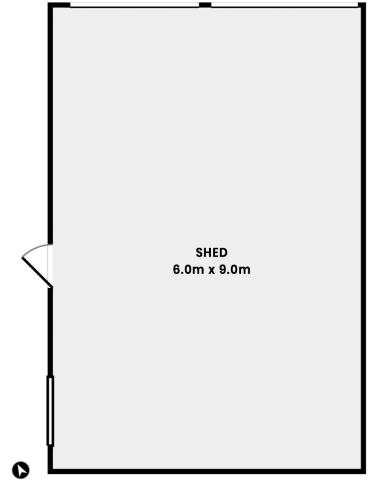

SHED
APPROX FLOOR AREA 53.5m²

Whilst every attempt has been made to ensure the accuracy of this floor plan, measurements of doors, windows, rooms and any other items are approximate and no responsibility is taken for any error, omission or mis-statement. This plan is for illustrative purposes only and should be used as such. The services, systems and appliances shown have not been tested and no guarantee as to their operability or efficiency can be given.