

**Vibrant city apartment with impressive boutique finishes**



**4/14-16 O'Connor Street, Chippendale**

**Sold Prior To Auction for \$530,000 (Aug 06, 2024)**

Placed less than 300 metres from Broadway for easy city access, this superior apartment will rapidly draw interest with an attractive location and look. 'The Benedict' features stylishly upgraded common areas, portraying a sense of refinement that is matched by the immaculate finishes of this apartment. The floorplan assures a high level of comfort with a walled bedroom space appointed with a built-in robe. High ceilings and hardwood flooring increase the appeal of this lifestyle pad, offering a vibrant north-facing living area with a generous balcony. First-time buyers and investors will recognise that this location offers everything for students and professionals seeking a cosmopolitan lifestyle, close to transport, universities, shopping centres and nightlife, while just two kilometres from Sydney's CBD.

- North facing with floor-to-ceiling glazing for maximum light
- Living space steps out to full-width balcony splashed in sunshine
- Kitchen with stone benchtop, gas stovetop & a dishwasher
- Cosy & quiet bedroom retreat provides a mirrored built-in robe
- Impeccable fully tiled bathroom with frameless glass shower

**Property ID:** L18336171

**Property Type:** Apartment

**Duncan Gordon**

0414 349 669

Duncan.Gordon@newtown.rh.com.au

- Sydney Uni, Notre Dame Uni & UTS are all located within 500m
- Placed only 850m from Redfern Station and 1.3km from Central
- Close to Toby's Estate Roasters & cafes along Abercrombie St
- Only 300m from Central Park Mall, 500m from Spice Alley dining
- 46sqm on title including the balcony

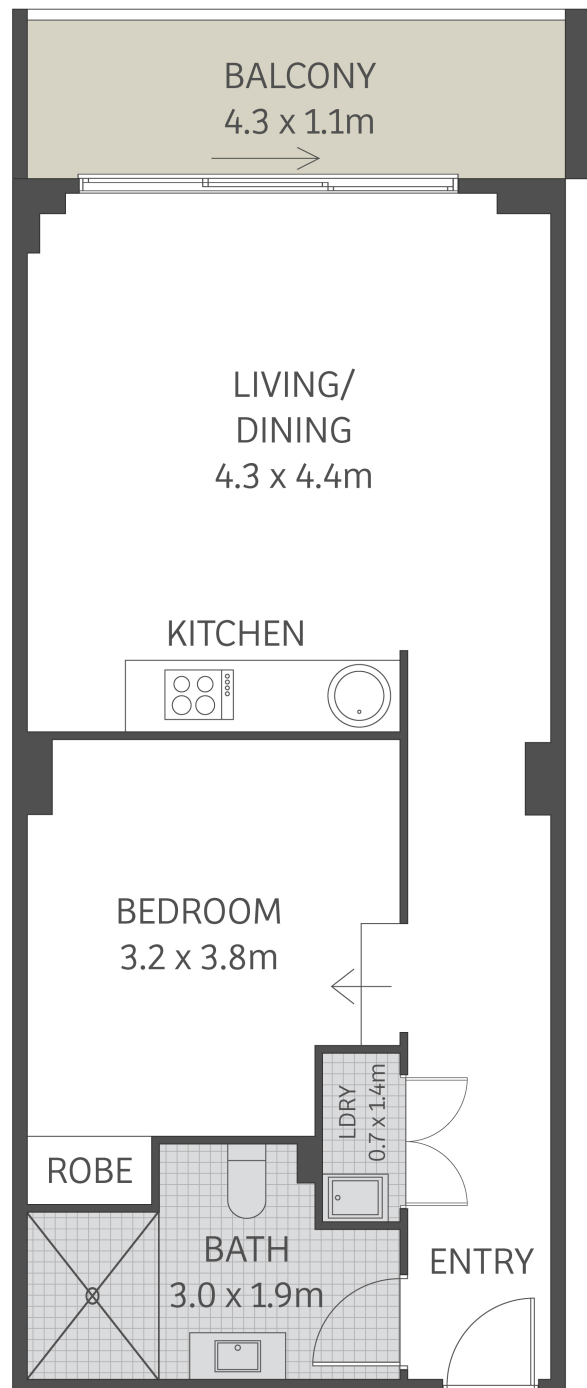
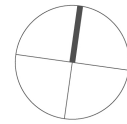

4/14-16 O'Connor Street, Chippendale

This floor plan is for marketing purposes and is to be used as a guide only.  
All efforts have been made to ensure its accuracy although interested parties are urged to rely on their own enquiries.