

Superb city lifestyle pad with immense versatility



11/54 Regent Street, Chippendale

Sold

Located for incredible convenience, this wonderful apartment scores with a flexible floorplan embellished with modern style points. The streamlined design provides generous space for dining and relaxing, with an attractive kitchen and a communal rooftop setting both making a lovely impression when entertaining. Bedrooms are ideally placed on either side of the apartment, and bed 2 can also be styled as an extension of living space and utilised as an enclosed outdoor area. It is part of a boutique collection of apartments converted from a Federation-era school building, set close to local cafes, train stations, Broadway Shopping Centre, UTS and the CBD.

- Sleek contemporary interior design with shadowline ceilings
- Stone kitchen benchtop, Fisher & Paykel electric appliances
- Both bedrooms have carpet & one provides a built-in robe
- Bed 2 with bi-folds also suits as space for a study or gym
- Fully tiled bathroom with stone benchtop, separate laundry
- Communal rooftop terrace with BBQ facilities & city outlooks

Property ID: L26372550

Property Type: Apartment

Building / Floor Area: 54

Duncan Gordon

0414 349 669

Duncan.Gordon@newtown.rh.com.au

- Located only 500m from UTS & 900m from Sydney University
- 280m from Central Park & Spice Alley, 800m from Broadway
- Easy stroll to World Square, Market City & Chinatown eateries

Please call me for more information about these – Duncan 0414 349 669

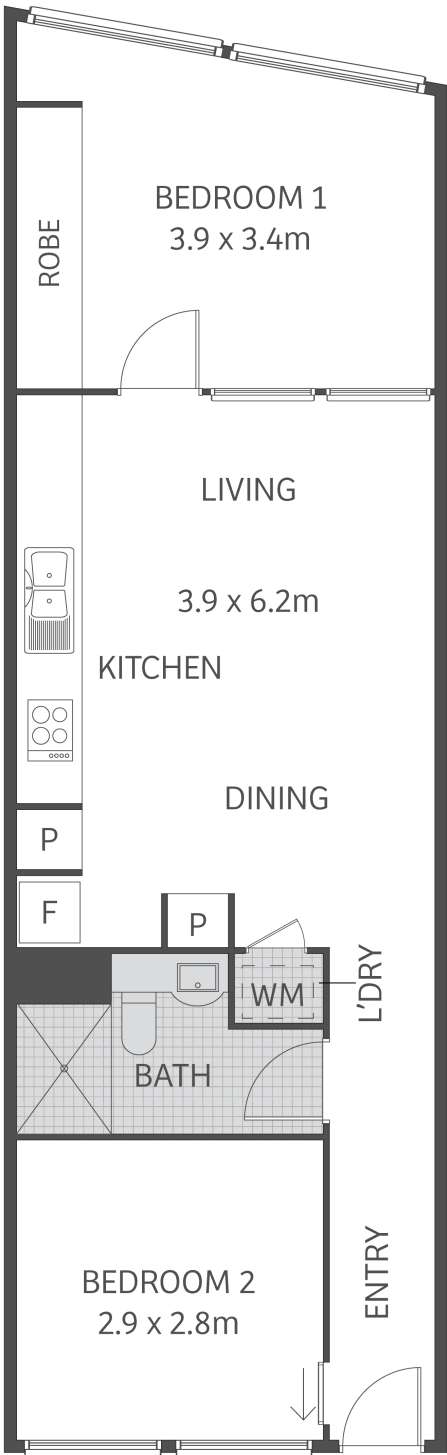
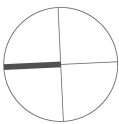

LEVEL THREE

This floor plan is for marketing purposes and is to be used as a guide only.
All efforts have been made to ensure its accuracy although interested parties are urged to rely on their own enquiries.