



RESIDE IN COMFORT AND STYLE



4



2



2

59 Mornington Avenue, Tarneit

Sold

Welcome to 59 Mornington Avenue in Tarneit!

Situated in a 336 sqm block, everyone has plenty of room to enjoy. Strategically located in the sought-after Grove Estate of Tarneit, it features 4 bedrooms and a study, including a master with WIR and ensuite. The property features a modern design with high-quality finishes throughout. The open-plan kitchen and living area are perfect for entertaining, while the bedrooms offer plenty of space and natural light.

FEATURES

- Master bedroom with walk-in robe (WIR) and ensuite:
- The other three bedrooms have built-in robes (BIR) and are serviced by a common bathroom and toilet.
- Practical modern kitchen with quality appliances including 900mm gas stovetop and oven, ranghood and dishwasher, overhead cabinetry & built-in pantry for ample storage.
- Open plan living & meals area leading onto a low-maintenance, generously sized backyard.

Property ID: L28931515

Property Type: House

Building / Floor Area: 181

Garages: 2

Land Area: 336.0 sqm

Lyn Castillo

0414 575 349

lyn.castillo@pointcook.rh.com.au

- Good size laundry and spacious linen cupboard along with a built-in linen pantry
- Study with a built-in robe (can be converted to a fifth bedroom)
- Remote-controlled double-car garage with internal access.
- Carpet flooring in the living quarters; and tiles in the common areas.
- Ducted heating is perfect for the winter cold, and evaporative cooling is to beat the summer heat.

This up-and-coming community in Tarneit showcases a lot of amenities and vibrant activity. Just 30km from the Melbourne CBD, everything is under a 5-minute drive from here, including the following;

- Over 15 hectares of open space and parklands;
- Future Tarneit West Train station, 15k capacity Wyndham stadium, Secondary School & Primary School, and Major Shopping Center;
- Tarneit station is only a 7-minute drive away (approx.);
- Davis Creek Primary, Islamic College of Melbourne, Good News Lutheran School, and other educational facilities are around the corner;
- Existing Shopping centers under 5km through Riverdale Village & Tarneit West Village
- Pacific Werribee Plaza is only a 10-minute drive away (approx.)

This is the perfect choice! Call Lyn now at 0414575349 to inspect and buy!

59 Mornington Avenue, Tarneit

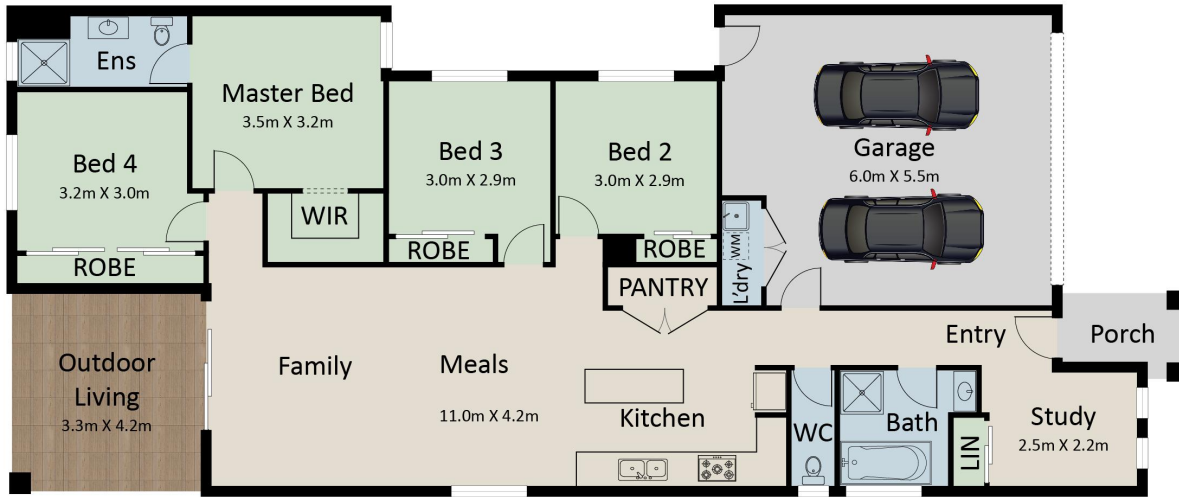

Disclaimer: Floor plan, measurements and appliances are approximate and are for illustrative purposes only.
Please refer to draftsmans plans for accurate measurements.