



Pet friendly courtyard apartment



1



1



1

G11/9 Wyuna Street, Beverley Park

Sold

Last remaining one bedroom courtyard apartment available at 'The Park' by MPG Apartments.

Designed by celebrated architects PBD and located in a quiet tree lined street this brand new one bedroom courtyard apartment offers the ultimate lifestyle sanctuary.

- Spacious open plan design, floor to ceiling glass doors
- Effortless integration to generously covered courtyard
- Dedicated study area with internet data socket
- Stylish kitchen, stone benchtops, oak veneer cabinetry, gas appliances
- Luxuriously appointed bathroom
- Ducted reverse cycle air conditioning
- Basement car space and storage

Property ID:	L21127852
Property Type:	Apartment
Building / Floor Area:	74
Garages:	1

Ian McDonald
0411373287
ian.mcdonald@cityliving.rh.com.au

- Security building, electric charging station, landscaped gardens
- Roof top entertaining area with BBQ and communal vegetable garden
- Another quality project by MPG Apartments

Apartment areas

Internal 50sqm

Courtyard 24sqm

Car space 14sqm

Storage 3sqm

Total 91sqm

For further information or private inspection contact Ian McDonald 0411373287

Disclosure: virtual furniture has been used in the photography of this property

5 - 11A WYUNA ST, BEVERLEY PARK

APT NO : G02, G11 (Mirrored)
INTERNAL AREA : 50 sqm
EXTERNAL AREA : 24 sqm
CAR SPACES : 1 x 13 sqm
STORAGE AREA : Minimum 2 sqm
TOTAL AREA : 89 sqm



KEY PLAN

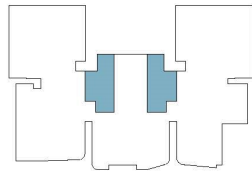

* THE LAYOUTS INDICATED ON THE MARKETING AND SALES PLANS ARE SUBJECT TO DA CONSENT CONDITIONS AND TO FUTURE STRUCTURAL AND SERVICES DESIGN AND INTEGRATION
* THIS FLOOR PLAN IS FOR MARKETING PURPOSES AND IS TO BE USED AS A GUIDE ONLY. ALL EFFORTS HAVE BEEN MADE TO ENSURE ITS ACCURACY AT TIME OF PRINT. CHANGES MAY BE MADE DURING THE DEVELOPMENT PROCESS AND DIMENSIONS, FIXTURES, FITTINGS, FINISHES AND SPECIFICATIONS ARE SUBJECT TO CHANGE WITHOUT NOTICE. PLEASE REFER TO CONTRACT DRAWINGS FOR MORE ACCURATE INFORMATION ON A PARTICULAR PROPERTY.
* ALL REASONABLE CARE HAS BEEN TAKEN IN THE PREPARATION OF THIS FLOOR PLAN. TO THE BEST OF OUR KNOWLEDGE, NO RELEVANT INFORMATION HAS BEEN OMITTED. HOWEVER, THE VENDOR AND ITS APPOINTED AGENTS DISCLAIM ALL LIABILITY SHOULD ANY INFORMATION OR MATTER CONTAINED HEREIN DIFFER FROM THE CONTRACT OF SALE OR THE ACTUAL CONSTRUCTED DEVELOPMENT.
* TILE SIZE AND LAYOUT ARE SHOWN INDICATIVE ONLY
* ALL AREAS AND PARKING ALLOCATION TO DRAFT AND FINAL STRATA PLAN PREPARED BY STRATA SURVEYOR

Raine & Horne
City Living