



Sold Off Market



103/55 Hill Road, Wentworth Point

Sold for \$615,000 (May 31, 2024)

Step into the welcoming embrace of your first home at the 'Regatta' building, developed by the award-winning Billbergia. This spacious haven provides ample room to breathe. The elongated courtyard with dual access, designed for entertainment, offers a peaceful retreat where you can welcome friends into the comfort of the outdoors.

Situated just 130 meters from the Parramatta Riverbank on the Wentworth Point peninsula, this modern apartment seamlessly blends quality design with stylish finishes. It is conveniently adjacent to Marina Square and Pier-side Shopping Centres, Public Library, Community Centre, and a Primary School. Additionally, it's only minutes away from the Bennelong Bridge to Rhodes.

Enjoy the best of both worlds: a self-contained peninsula community with excellent access to the greater Sydney area via road, rail, or ferry. You will love living in the vibrant community of Wentworth Point.

Features:

- High ceiling, open plan living that flows onto the generous courtyard-sized terrace, with planter and green plants.

Property ID:	L27695541
Property Type:	Apartment
Building / Floor Area:	113
Carports:	1

Alvin Cai

0425575123

alvin.cai@rhodes.rh.com.au

- King sized bedroom with built-in-wardrobes & plentiful natural light
- Air-conditioned bedroom & lounge room
- Gourmet gas kitchen with blue stainless steel appliances & a mass amount of cupboard & pantry
- Superb spacious bathroom with dual access
- Internal laundry with combined washer & dryer
- Secure car space & storage cage
- Just minutes to Wentworth Point Ferry Wharf, Bus Services, Water, Parklands & Bennelong Bridge (Footbridge) to Rhodes.
- Low strata and healthy sinking fund.
- Total area on title: 128 sqm

Don't wait to call our friendly team now for more information.

Disclaimer: All information contained herein is gathered from sources we believe to be reliable; we cannot guarantee accuracy. Any interested parties should rely on their own enquiries.

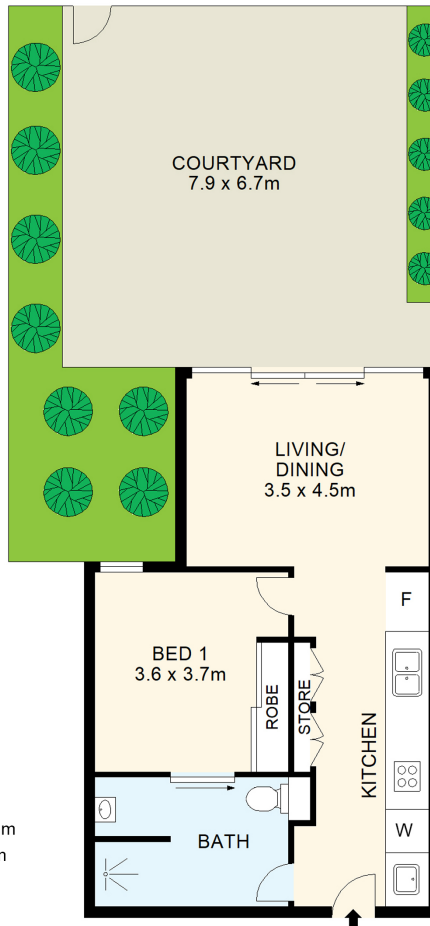

Living: 113 sqm
Total: 128 sqm

STORE



Raine&Horne®

DISCLAIMER: THIS IS FOR ILLUSTRATIVE PURPOSES ONLY.
ALL DIMENSIONS ARE APPROXIMATE AND IT DOES NOT
CONSTITUTE PART OF ANY LEGAL DOCUMENTS.

ADDRESS:

103/55 Hill Road, Wentworth Point, NSW 2127