



Spacious Home with Unique Layout



4



2



1

18 Pegasus Street, Erskine Park

Sold for \$1,050,000 (Jul 15, 2024)

Quietly situated within the sought-after neighbourhood of Erskine Park, this refreshed brick veneer home is only moments from Erskine Park Shopping Centre, local schools, bus stops, and the M4 Motorway.

What We LOVE About This Home:

- Upon entering the home, you will be greeted by a spacious L-shaped living and dining design, seamlessly connecting you to the rest of the home
- Flowing from the dining area is the renovated kitchen space, perfect for the home chef
- All four bedrooms are generously sized and come complete with built-in wardrobes
- The main bedroom features direct access to the main bathroom
- A second full bathroom is located adjacent to the fourth bedroom, perfect for larger families
- Two zoned air-conditioning to keep you comfortable year-round
- The home also features a spacious rumpus room at the rear, taking you out the backyard

Property ID: L27584908

Property Type: House

Garages: 1

Land Area: 625.2 sqm

Jack Turner

0434554430

jack.turner@stmarys.rh.com.au

- Step outside and you'll find an undercover entertaining area, garden sheds and loads of grassy area

Don't miss the opportunity to break into the Erskine Park market and make this your home. Contact Terry Freeman on 0415 999 754 or Jack Turner on 0434 554 430 to secure your inspection.

- All information contained herein is gathered from reliable sources, however we cannot guarantee its accuracy and all persons should rely on their own enquirers. Distances & amounts are approximate *

18 Pegasus St, Erskine Park

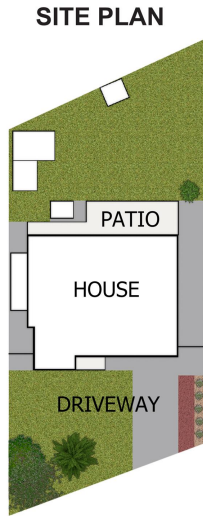

DISCLAIMER:

This floor plan is used for marketing purpose only and is subject to errors and inaccuracy. The marketing Agent & N2 Media will not accept any liability. Interested parties should make and rely on their own enquiries.

FLOOR PLAN

