

Elevate Your Lifestyle: Discover Opulence in Q1's Exclusive 63rd Floor Residence



3



2



3

6304/9 Hamilton Avenue, Surfers Paradise

Sold

Step into 6304 Q1 which offers a world of exquisite beauty with stunning ocean, city, and hinterland vistas greeting you from every room. This magnificent 241sqm Skyhome is filled with natural light and the expansive floor plan creates a seamless, airy atmosphere throughout.

This exceptional property offers a blank canvas to transform into your dream home or is ready for immediate holiday or long-term rentals. One of only 4 apartments on level 63, step out of the express lift to enter through expansive double doors and be greeted by astounding coastline views all the way to Coolangatta and across the waterways beyond the hinterland. The spacious living area opens onto an open balcony making the perfect space to entertain or unwind soaking in the picturesque outlook.

The fully-equipped kitchen with island bench- including gas cooking- seamlessly flows into a separate living / dining room and features a sky garden balcony, providing the ultimate year-round entertaining venue. Delight in the mesmerizing Surfers Paradise skyline during the day, as the ocean sparkles, and be enchanted by the city lights twinkling at night. Retreat to any of the three generously sized bedrooms and indulge in sweeping views of the hinterland and Gold Coast waterways.

Located within the iconic Q1 Resort, this extraordinary property offers the epitome of coastal

Property ID: L25425598

Property Type: Apartment

Building / Floor Area: 241

Garages: 3

Ben Brackenridge

0484290982

ben.brackenridge@surfers.rh.com.au

living in Surfers Paradise. Immerse yourself in a vibrant lifestyle with an abundance of dining, entertainment, and shopping options, and enjoy direct access to the golden sands of the renowned Surfers Paradise beach, just steps away. Effortlessly explore the surrounding area with convenient public transport options, including the 'Surfers Paradise' G:link tram stop right at your doorstep.

Property Highlights:

- Panoramic Gold Coast views looking south all the way down to Coolangatta and over the city, waterways and to the hinterland
- Spacious and inviting open plan lounge, separate dining area and abundance of storage
- Kitchen with island bench and gas cooking flowing onto dining
- Expansive enclosed balcony opening onto rarely available outdoor balcony with breathtaking vistas
- Additional feature sky garden balcony off kitchen and dining with views to the hinterland and north to the Broadwater
- Luxurious master bedroom featuring walk-in wardrobe, ensuite and breathtaking ocean vistas
- Generously proportioned second and third bedrooms with built-in mirrored wardrobes and hinterland views
- Well-appointed bathrooms with floating vanity and stone benchtop, additional powder room and separate laundry
- Ducted air-conditioning throughout for ultimate comfort
- 3 secure separate basement car spaces
- Size: 241sqm of sheer opulence

Q1 Resort amenities include:

- Two outdoor lagoon-style pools
- Indoor pool and spa
- State-of-the-art gymnasium
- Spa, sauna, and steam room
- Be pampered at Stephanie's Wellness Day Spa
- Enjoy entertainment at the state-of-the-art cinema and games rooms
- Relish delectable cuisine at Longboards Laidback Eatery and Bar, a licensed restaurant

- ‘Skypoint Observation Deck’ situated on the 77th floor, offering an elevated dining and drinking experience 230 meters high, with 360-degree views of the Gold Coast at

Skypoint Bistro and Bar

- 24-hour security and attentive onsite managers

For all enquiries or to arrange an inspection, please contact Ben Brackenridge at 0484 290 982 or via email ben.brackenridge@surfers.rh.com.au.

Apt. 6304 Q1, Surfers Paradise

3 2.5 3
total area: 241 m²

Raine & Horne
Ben Brackenridge 0484 290 982

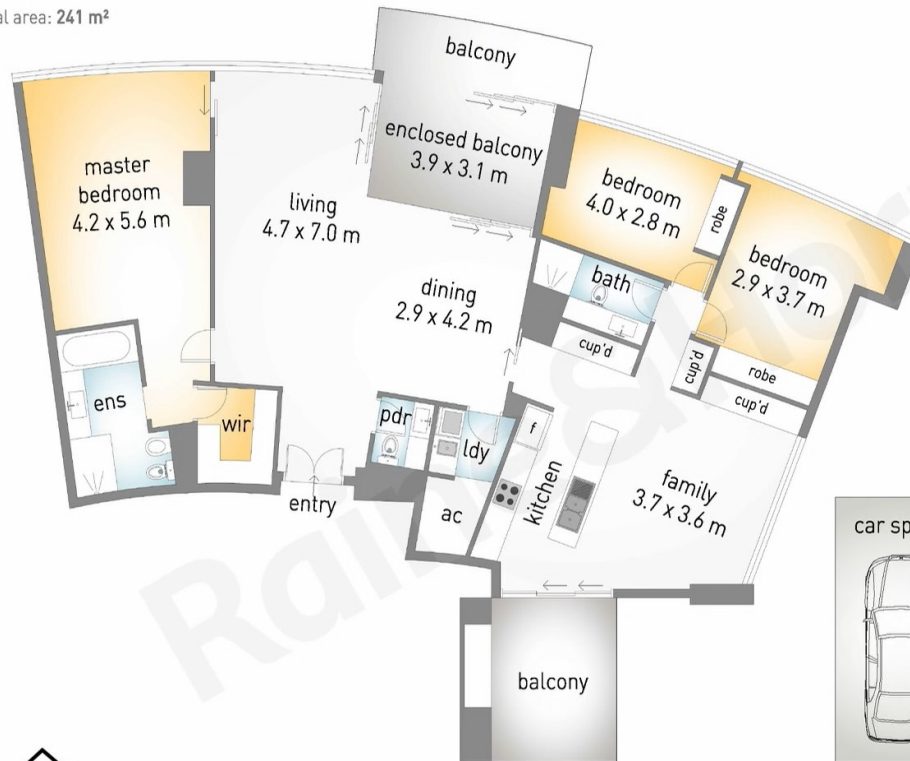

Dimensions are approximate. All information contained herein is gathered from sources we believe to be reliable. However we cannot guarantee its accuracy and interested persons should rely on their own enquiries.