



## Impeccable Craftsmanship



## 4 Myrtle Forest Drive, Milton

Sold

Introducing this stunning recently constructed residence, beckoning you to embrace the vibrant lifestyle of Milton. Situated in close proximity to the fashionable Milton village, famed for its array of charming cafes, boutique shops, and delightful eateries, this home offers the epitome of modern living fused with timeless elegance.

Step into a world of tasteful luxury, where impeccable craftsmanship and an abundance of natural light define every corner of this designer abode. Boasting a thoughtfully designed layout, this home comprises four bedrooms, a media room, and a study, with the master suite opening onto the lush garden with a deck perfect for morning coffee.

The heart of the home lies in its centralised kitchen, complete with a Caesarstone island bench and a convenient walk-through Butler's pantry, seamlessly connecting to the open-plan dining and living areas. Entertain guests or enjoy family dinners in the expansive alfresco space, perfectly complemented by the tranquil backdrop of the cottage-style garden adorned with roses, ornamental pear trees, and lavender bushes.

Notable features include plantation shutters, high-profile doors and skirtings, luxurious kitchen and bathroom finishes, S-fold sheers, and 100% wool carpets in the bedrooms. The attention to detail and quality craftsmanship are evident throughout this exceptional residence.

**Property ID:** L13144724

**Property Type:** House

**Garages:** 2

**Land Area:** 651.0 sqm

**Robert Granger**

0448 175 761



rgranger@mollymook.rh.com.au

## Highlights:

- State-of-the-art gourmet kitchen with a freestanding 900mm stove featuring a gas cooktop
- Under-mount sinks in both the kitchen and Butler's pantry
- Plumbed-in fridge connection for added convenience
- Seamless integration of kitchen and dining areas leading to the Blackbutt hardwood entertaining deck
- Impressive 2.7m ceilings, high-profile doors, and skirting boards
- Comfortable living ensured by a 5 Kw reverse cycle split air conditioning system and gas connection
- High clearance double garage with dual driveway access
- Media room equipped with retractable screens on French doors
- Master suite with TV connection and remote-controlled ceiling fan for added comfort
- Double basin vanity in ensuite and generous walk-through wardrobe
- External gas connection and weatherproof power point for outdoor BBQ
- Gravelled parking bay designed for boat or caravan storage
- Enchanting cottage-style landscaped gardens enclosed by a scalloped white picket fence
- Raised vegetable garden beds adjacent to the alfresco area
- Conveniently located just a short stroll from Milton shops, the popular Harvest restaurant and Altar Wine Bar, and the Milton Showground, where you can enjoy off-leash runs with your furry companions.

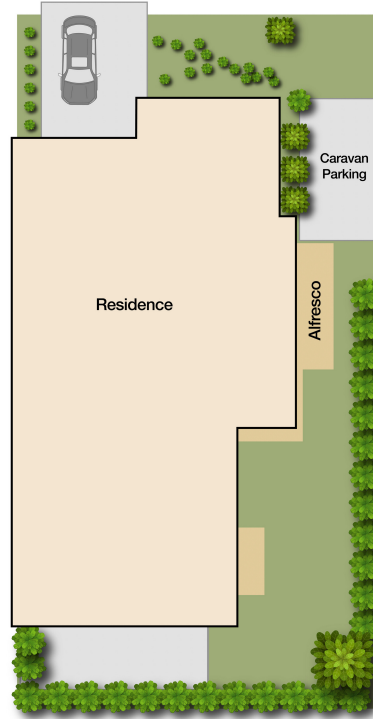
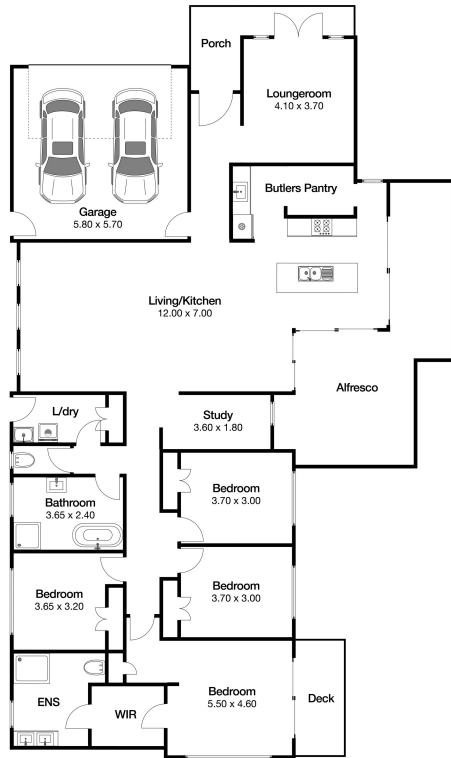
Don't miss the opportunity to make this exquisite residence your new home and embrace the essence of Milton's coveted lifestyle.

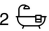

INTERIOR	248m <sup>2</sup>
4 	2 
	2 

## 4 Myrtle Forest Dr Milton

**Disclaimer:** The artist impressions and floorplans are indicative only, are not to scale and do not form part of any Contract of Sale. Any dimensions, finishes or specifications depicted are subject to change without notice. Consultants and agents do not warrant the accuracy of any information provided and do not accept any liability for negligence, any error, misrepresentation, discrepancy in the information or reliance thereon.